

Finding of Emergency

The Department of Justice (Department or DOJ) finds that an emergency exists, and that the immediate adoption of sections within Chapter 39, of Division 5, of Title 11 is necessary to avoid serious harm to the public peace, health, safety, or general welfare.

Specific Facts Demonstrating the Need for Immediate Action

Proposition 63, a measure banning the possession of large-capacity magazines, was approved by the voters on November 8, 2016 and took effect November 9, 2016. In anticipation of its passages, the Legislature pre-amended Proposition 63 with the passage of Senate Bill 1446 (Chapter 48, Statutes of 2016). The clarifying amendments take effect on January 1, 2017.

Pursuant to Proposition 63, as amended, beginning July 1, 2017, it will be an infraction punishable by a fine for a person to possess any large-capacity magazine, regardless of the date the magazine was acquired. (Penal Code, § 32310, subdivision (b).) The new law requires a person in lawful possession of a large-capacity magazine prior to July 1, 2017 to dispose of the magazine. Some persons are exempt from the ban, including active and retired law enforcement, armored car entities, and licensed gun dealers. (Penal Code, §§ 32400, 32405, 32406, 32410, 32430, 32435, 32450.) Starting July 1, 2017, anyone who violates the ban is subject to a year in jail, and a \$100 fine for a first offence, \$250 fine for a second offense, and a \$500 fine for a third offense. (Penal Code § 32310, subdivision (b).)

These emergency regulations are necessary for the implementation and on-going enforcement of the ban on large-capacity magazines. The proposed regulations provide guidance to California residents on how to comply with the ban. These regulations need to be established as soon as possible so the Department has time to notify gun owners and gun owners have time to make the necessary changes to comply with the ban.

There are likely hundreds of thousands of large-capacity magazines in California at this time. In recent years, there has been an increase in these types of firearms on the market. The Department therefore expects many gun owners to be affected by the new ban. Under the new law, gun owners have six months to dispose of or permanently alter their large-capacity magazines. Pursuant to Penal Code section 32310, subdivision (c), a person who legally possesses a large-capacity magazine shall dispose of that magazine by any of the following means prior to July 1, 2017: (1) remove the large-capacity magazine from the state; (2) sell the large-capacity magazine to a licensed firearms dealer; (3) destroy the large-capacity magazine; or (4) surrender the large-capacity magazine to a law enforcement agency for destruction.

Alternatively, gun owners may permanently alter large-capacity magazines by reducing their ammunition capacity so that it no longer meets the definition of a “large-capacity magazine.” Penal Code section 16740 defines “large-capacity magazine” to mean any ammunition feeding device with the capacity to accept more than 10 rounds, but shall not be construed to include a feeding device that has been permanently altered so that it cannot accommodate more than 10 rounds. If a gun owner chooses to permanently reduce the capacity of their large-capacity

magazines, these emergency regulations provide guidance for doing so with what the Department has determined to be the acceptable minimum level of permanence.

By providing this information to the public in a timely manner, through the emergency process, the Department will avert serious harm to public peace, health, safety, or general welfare.

Technical, Theoretical, and Empirical Study, Report, or Similar Document, if any, Upon Which the Department Relied

In addition to existing regulations forming the basis of these proposed regulations, the following documents were used:

UTAS MAKINE LTD., UTS-15 owners manual, attached for reference
KEL TEC, KSG owners manual, Rev 042814, attached for reference
Standard MFG. DP-12 shotgun owners manual, attached for reference

Authority and Reference Citations

Authority: Penal Code sections 26905, 26910, 32310, 32311, 32315.

Reference: Penal Code sections 16740, 32310, 32311, 32315, 32400, 32405, 32406, 32410, 32415, 32425, 32430, 32435, 32440, 32445, 32450.

Repealed: Penal Code section 32420 was removed from the authority of section 5480 because SB 1446 repealed that section.

Informative Digest/Policy Statement Overview

Existing law prohibits the sale, gift, and loan of a large-capacity magazine. A violation of this prohibition is punishable as a misdemeanor with specified penalties, or as a felony. The new law goes further and provides that possession of large-capacity magazines by a non exempt person is an infraction punishable by a fine not to exceed \$100 for the first offense, by a fine not to exceed \$250 for the second offense, and by a fine not to exceed \$500 for the third or subsequent offense, regardless of the date the magazine was acquired. The law requires a person in lawful possession of a large-capacity magazine prior to July 1, 2017, to dispose of the magazine as provided. By creating a new crime, this law imposes a state-mandated local program.

Existing law creates various exceptions to the prohibition on the sale, gift or loan of a large-capacity magazine including, but not limited to, the sale of, giving of, lending of, importation into this state, or purchase of, any large-capacity magazine to, or by the holder, of a special weapons permit for use as a prop for a motion picture or any federal, state, county, city and county, or city agency that is charged with the enforcement of any law, for use by agency employees in the discharge of their official duties, whether on or off duty, and where the use is authorized by the agency and is within the course and scope of their duties. The new law makes conforming changes to those exceptions by including possession of a large-capacity magazine in those provisions and would establish additional exceptions, including exceptions to allow

licensed gunsmiths and honorably retired sworn peace officers to possess large-capacity magazines.

The objective of the proposed regulations is to inform California gun owners of their options for complying with new California laws while maintaining public safety.

Article 4. Large-Capacity Magazine Permits

§ 5480. Requirements for Large-Capacity Magazine Permits Pursuant to Penal Code Section 32315.

This section is amended to state that a separate Large-Capacity Magazine Permit is needed for each licensed location. The permit will automatically transfer with an existing California Firearms Dealer if their physical store moves and they notify the Department prior to moving. Large-Capacity Magazine Permit applications can only be submitted online.

§ 5483. Large-Capacity Magazine Permit Record Keeping.

This section is amended to include instructions on how permittees shall document the Large-Capacity Magazine Permit records, which form to use, any additional documentation to be kept with the form, and timeframe for completing the documentation.

§ 5484. Large-Capacity Magazine Permit Revocations.

This section is amended to include the grounds for revocation of a Large-Capacity Magazine Permit, and the factors surrounding the revocation.

Article 5. Large-Capacity Magazines and Large-Capacity Magazine Conversion Kits

§ 5490. Large-Capacity Magazine; manufacturing

This section has been added to inform gun owners who legally possess a large-capacity magazine that they may disassemble and clean the magazine without triggering the ban.

§ 5491. Large-Capacity Magazine; capacity

This section has been added to inform gun owners of the legal definition of a large-capacity magazine and provide guidance on reducing the capacity on their large-capacity magazines.

§ 5492. Large-Capacity Magazine Conversion Kits.

This section has been added to clarify the definition of large-capacity magazine conversion kits.

Government Code Section 11346.5(a)(3)(D) Evaluation

The proposed regulations are not inconsistent or incompatible with existing state regulations.

Mandate on Local Agencies or School Districts

The Department has determined the proposed emergency regulations do impose a state-mandated local program or a mandate requiring reimbursement by the State pursuant to Chapter 58, Statutes of 2016, because it creates a new crime. However, SB 1446 states that no reimbursement

is required by this act pursuant to Section 6 of Article XIII B of the California Constitution because the only costs that may be incurred by a local agency or school district will be incurred because this act creates a new crime or infraction.

Other Matters Prescribed by Statute Applicable to the Agency or to Any Specific Regulation or Class of Regulations

None.

Nonduplication of State Statutes as Necessary To Satisfy Government Code Section 11349.1(a)(6)

To satisfy the requirements of Government Code section 11349.1(a)(6), the text of the proposed regulations are nonduplicative.

Forms Incorporated by Reference

Large-Capacity Magazine Permit Application, BOF 050 (Rev. 12/2016)
Large Capacity Magazine Report, BOF 1002 (Rev. 12/2016)

Cost Estimates

The Department has assessed the potential for significant adverse impact that might result from the proposed emergency action and has determined:

- There will be no non-discretionary costs or savings to local agencies
- There will be no costs to school districts
- There will be no costs or savings in federal funding to the State

As detailed on the attachment to the Economic and Fiscal Impact Statement (STD. 399), the Department estimates its costs (state agency) directly related to the large-capacity magazine permit and enforcement of the large-capacity magazine laws and regulations will be insignificant.

Finding of Emergency

Government Code section 11346.1(a)(2) requires that, at least five working days prior to submission of the proposed emergency action to the Office of Administrative Law, the adopting agency provide a notice of the proposed emergency action to every person who has filed a request for notice of regulatory action with the agency. After submission of the proposed emergency to the Office of Administrative Law, the Office of Administrative Law shall allow interested persons five calendar days to submit comments on the proposed emergency regulations as set forth in Government Code section 11349.6.

Explanation of Failure to Adopt Nonemergency Regulations

The Department is unable to develop regulations in the standard manner because of the short timeframes provided in the legislation. The legislation was signed into law on July 1, 2016, and the ban commences on July 1, 2017. It is the Department's intention to provide guidance to California's gun owners so that by July 1, 2017, they will be in compliance with the law. The proposed regulations provide options for disposal of large-capacity magazines, as well as instructions for reducing the capacity of a large-capacity magazine, and need to be formalized and provided to California residents as soon as possible.



OWNER'S MANUAL

Instruction Book for UTS-15 Shotgun

www.utas-usa.com

UTS15



www.utas-usa.com

OWNER'S MANUAL

Instruction Book for UTS-15 Shotgun

Introduction.....	4-5
Ten commandments of safety	6-12
Important Parts & Mechanism	13-15
Loading and Firing	16-23
Unloading.....	24
Cleaning.....	25-28
Complete Disassembly.....	29-51
Exploded View & Part List	52-54
Parts and Service	57

Introduction

Congratulations on your purchase of the UTS-15 Shotgun. This shotgun is on the cutting edge of modern shotgun design and materials utilization. Developed by UTAS MAKINE LTD and manufactured in the United States and Turkey, the UTS-15 is sure to change the way sportsmen as well as military and law enforcement personnel view a shotgun and its capabilities.

UTAS is a company that specializes in firearms design, engineering and OEM manufacturing. Arguably, UTAS is one of the top sporting firearms design companies with their products being voted “Gun of the Year” by the NRA’s American Rifleman Magazine in 2006 and again in 2007. Although UTAS continues to win awards for beautiful designs, the heart of the company is innovation as exemplified in the revolutionary new UTS-15.

The UTS-15 is a unique shotgun platform not previously seen by the American shooter. The UTS-15 platform is to the shotgun shooter as the AR platform is to the center fire rifle shooter. The UTS-15 is offered in several hunting configurations as well as a Military and Law Enforcement specification. While the sporting model has twin magazines of 5 round capacities requiring manual magazine selection, the M&P model offers a total magazine capacity of 15 rounds with consecutive automatic magazine selection. The M&P model has additional law enforcement enhancements

including a flash suppressor extended choke and an integral laser / spotlight night sight designed for close-quarters combat situations. You will find that the UTS-15 is equally at home in shooting 2 $\frac{3}{4}$ " or 3 inch ammunition. Additionally, the UTS-15 will reliably feed specialty rounds loaded in 2 $\frac{1}{2}$ inch cases. A variety of sporting choke tubes is available from cylinder bore for big game such as wild boar, bear or deer with buckshot or slugs to an extra full turkey choke.

As with any firearm, you are asked to become familiar with the UTS-15 and this operator's manual even before you take it out of the box. It is impossible to be too careful when it comes to firearms safety. Most firearms accidents could be prevented with just a few simple rules such as controlling the direction of the muzzle, proper operation of the safety mechanism and utilization of the proper loads designed for your particular firearm. The UTS-15 is not your father's shotgun. Take your time, use your head, be safe with this new and exciting shotgun and it will provide you with a lifetime of shooting enjoyment.

Warning!

Failure to follow any of these safety precautions and the Ten Commandments of Firearms Safety may cause personal injury including death to the shooter or to bystanders as well as substantial property damage. If you have any questions regarding your UTS-15 or its safe operation, please call **UTAS-USA at (+1) 847 768 1011**. We will be happy to talk to you.

The ten commandments of firearm safety

The following Ten Commandments of Firearm Safety should be committed to memory and kept in mind anytime you are handling firearms whether on the range, in the field or at home for cleaning and storage. Please give these commandments your full attention and obtain a thorough understanding of these rules. Mistakes can be made by even the most experienced shooter. Make sure that is not you by memorizing and faithfully practicing these Ten Commandments of Firearms Safety.

First commandment

Always keep the muzzle pointed in a safe direction.

This commandment is listed first and is number one because it is the most important rule to remember and follow.

If your muzzle is always pointed in a safe direction, you can never have an accidental discharge that will cause any injury or damage. Never allow your gun to point in any direction or at anything you do not want to shoot. This rule applies to your firearm whether it is loaded or not and particularly when either loading or unloading your firearm.

Second commandment

Firearms should be unloaded when not actually in use.

Your firearm should only be loaded when you are at the range or in the field and actually ready to shoot. When you have finished shooting, unload the firearm before putting it in your vehicle, tent or home. Always remember to unload the firearm completely. This means removing all ammunition not only from the chamber but the magazines as well. Anytime you are given a firearm, check to see if it is unloaded. Do this as well when passing a firearm to another person. The mark of a real firearm pro is to always know the loading condition of any firearm you are handling. Always use good common sense. If you are climbing into a tree stand, crossing a fence, stream or other obstruction, unload your firearm. Do not store firearms loaded. Be particularly careful around children who are often fascinated with firearms. Lock your firearms away and secure your ammunition in a separate storage facility

Third commandment

Do not rely on your firearm's safety.

Your UTS-15 has a safety designed to maximize performance and safety. It is, however, a mechanical device and is subject to failure. Always keep your safety engaged until you are ready to take your shot. Never put your finger on the trigger until you are ready to take your shot. Do not pull the trigger just to “test the safety”. Before using your new shotgun, read the owner’s manual carefully and be completely familiar with the exact location and operation of your firearm’s safety mechanism. Always know that you and your good judgment are the best safety mechanism for your firearm.

Fourth commandment

Be sure of your target and what's beyond it

Once you have pulled a trigger and released a round, you can never get it back. Know what you are shooting. Never take a “sound shot” or fire at a movement or flash of color. It might well be your hunting buddy. Know what is behind your target in case you miss or experience a ricochet. Bullets and shot charges can carry great distances and with lethal effect.

Fifth commandment

Use proper ammunition.

Your UTS-15 shotgun is designed to be used only with 12 gauge ammunition of no greater case length than three inches. Using the wrong ammunition or using ammunition that has been improperly loaded can cause serious personal injury and even death. It certainly can destroy your firearm. The most common ammunition error in 12 gauge shotgun shooting is called a 12/20 burst. This is when a 20 gauge shell is loaded into a 12 gauge gun by mistake. The 20 gauge shell will slide through the 12 gauge chamber and lodge in the bore. When a 12 gauge shell is then loaded and fired, the burst results. These situations have the potential to be fatal to both the shooter and those around the shooter. Always carefully check the markings on your ammunition to insure that what you are using is intended for your particular firearm. If you are using reloaded ammunition, be particularly careful to know that you are using properly reloaded shells.

Sixth commandment

If your firearm fails to fire when the trigger is pulled, handle with care.

Should this happen to you, remember the first commandment and keep your muzzle pointed in a safe direction. It may be a simple misfire where the primer did not ignite the propellant charge. It could also be what is known as a “hang fire” where the powder does not discharge immediately but might do so a second or two after the trigger is pulled. Keep your muzzle pointed in a safe direction, keep your face away from the ejection port, put the safety on and carefully unload the action. Safely dispose of the defective round. Throughout this procedure, always remember that the gun might discharge at any time.

Seventh commandment

Always wear eye and ear protection when shooting.

Your sight and hearing are always at risk when shooting. This is particularly true in clay target shooting or in confined spaces such as a duck blind or enclosed deer stand. Always use proper eye and ear protection. Most of us only have two eyes and two ears. Take care of them through proper protection when shooting.

Eighth commandment

Be sure the barrel is clear of obstructions before shooting.

This procedure starts before you load your gun. Open the action and make sure that both the chamber and the magazines are clear. Check the barrel for any obstruction or debris. A very small obstruction such as a cleaning patch, snow, mud or similar object could well be enough to destroy your gun and hazard your life and limb. Never try to clear an obstruction by shooting a round through the barrel. If you notice something not quite right with the recoil or report when you fire your shotgun, stop, unload the gun and check the bore for obstructions.

Ninth commandment

Don't alter or modify your gun and have it serviced regularly.

Your UTS-15 shotgun has been designed to operate within certain factory specifications. If you make any attempt to alter the trigger pull, safety mechanism or any other feature in any way you might jeopardize your safety and the safety of others around you. All mechanical devices are subject to failure through wear, misuse or poor maintenance. Make sure that you periodically have your shotgun serviced and inspected by a competent service facility. The best way to insure continuing serviceability is proper cleaning and lubrication. Before cleaning, always make sure that your firearm is completely unloaded. If possible, clean the bore from the chamber end to the muzzle end.

Tenth commandment*Learn the mechanics and handling characteristics of your firearm.*

You might be a real firearm pro but not all guns are alike in features, operation and performance. This is particularly true of the UTS-15 which represents a new and totally different shotgun platform. Read your instruction manual from cover to cover. Become familiar with all the different component parts and operating features. As an additional note, alcohol and gun powder DO NOT MIX! Always shoot sober. Never consume anything that will impair your judgment when it comes to using firearms. A majority of the firearms accidents in the world every year involve the use of drugs and alcohol. Stay safe! Stay alive! SHOOT SOBER!

Safety Mechanism

As indicated in illustration the tip of the safety selector is pointed at S for safety. To fire the switch is rotated clockwise until the tip is pointed at the F for fair.

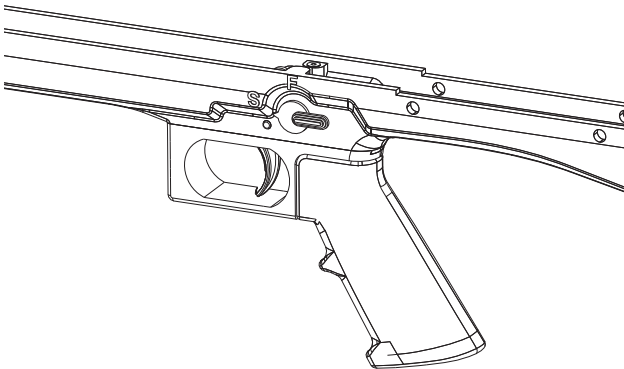

Fore-end

This is used to pull the bolt rearward to open the action and to load another round after firing.

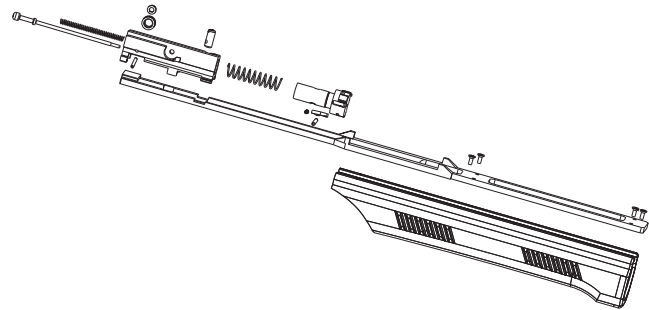

Action Bar Release (bolt release) *Trigger*

The action bar release is used to unlock and operate the action when the trigger has not been pulled.

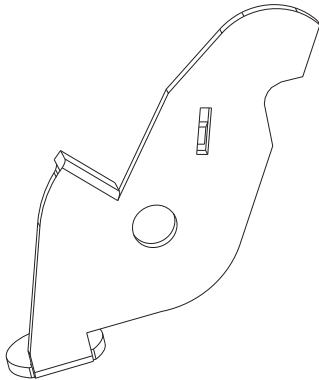

Pulling the trigger will discharge the firearm if the chamber has a loaded round in it. The weight of the trigger is set at the factory. Do not attempt to adjust the trigger. To do so might result in an unsafe condition resulting in accidental discharge.

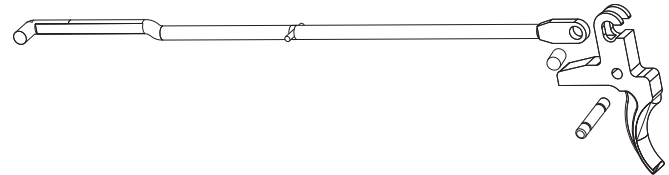

Choke Tubes

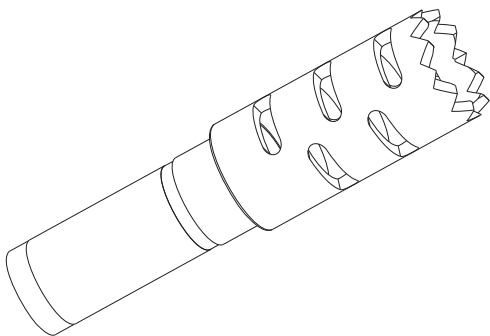

Warning

Unload the firearm completely before attempting to change a choke tube. Leave the action open and the chamber and magazine empty.

To change the choke tube:

- Point the firearm in a safe direction.
- Engage the safety.
- Place the choke tube wrench into the choke tube.
- Turn the wrench counter clockwise to remove the choke tube.
- Screw in the new choke tube with the wrench.
- Tighten the choke tube snugly but **DO NOT OVERTIGHTEN**. With the action open and the chamber empty, check the choke tube occasionally to make sure the tube has not become loose.
- **NOTE:** NEVER fire the firearm without a choke tube installed.

UTS-15 Owners Manual Additions

Loading and Firing

At the range after removing your UTS-15 from it's protective carton or deployment case, check to make sure the safety is in the on safe position (picture 1)



depress the bolt release button (picture 2)



and slide the action into the full rear position to insure the chamber is empty, then raise the upper stock (picture 3)



to visually confirm that there are no live shells in either magazine tube (picture 4).

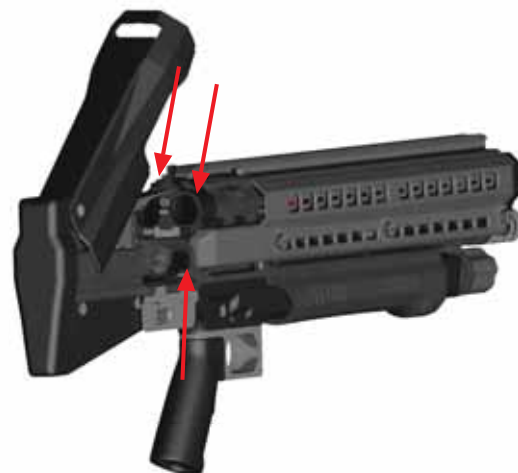



With the upper stock raised you will be able to see the serial number plate on the left side of the receiver (picture 5).



It is a good idea to record this serial number and place it in a safe place in case your UTS-15 is ever lost or stolen.

After confirming that your UTS-15 is in fact empty, check again to make sure the safety is in the safe position, then check that the extended choke tube, tactical choke or barrel extension are fully screwed in and snug (picture 6).

Open the loading port doors by pressing down on the loading door release latch (7).

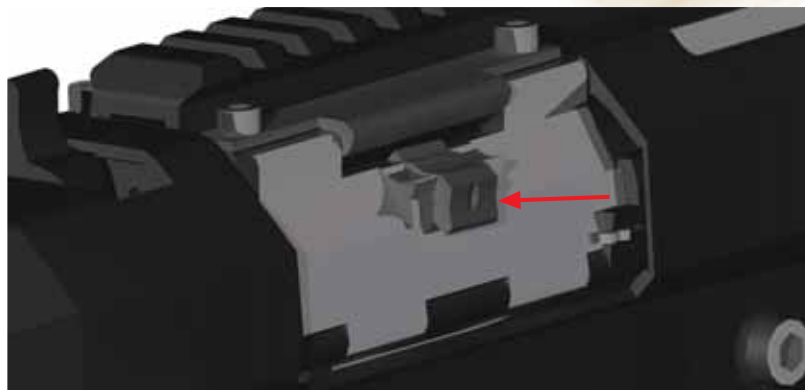

The shell follower should then be pushed forward with the end of your thumb until it passes the magazine shell catch (8).

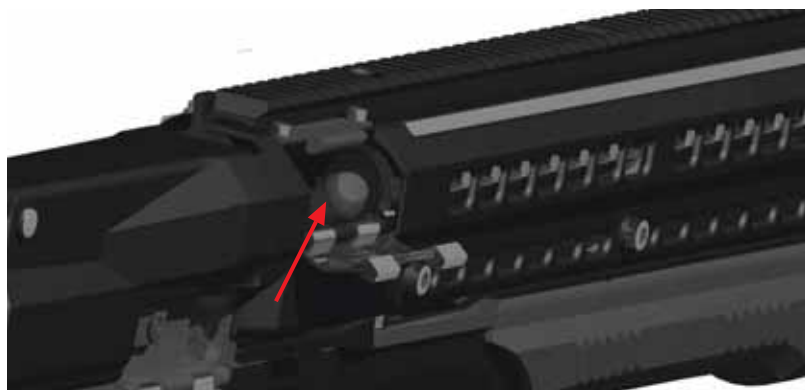



Six 2 ¾" 12 gauge shells or five 3" shells can now be loaded into each magazine tube; the remaining shell can then be place in the open monobloc loading port (10).



which will hold the magazine follower in the magazine tube, leaving the monobloc port open to receive shells (9).

When the loading port door is closed the shells held in the magazine tube will be released, charging the full seven 2 ¾" or six 3" shells into the ready to load position, with an audible sound of the shells moving rearward to the rear of the monobloc.

Visual inspection to confirm that the magazine is full charged can be achieved by viewing the cartridge counter indicator the viewing ports in the side of the aluminum magazine tube (11)



Now with both magazines fully charged and the action in the full rear position the 15th shell can be placed directly in the chamber of the barrel (12).



UTS15



With the UTS-15 pointed down range and the magazine selector in the center position if a full 15 rounds is to be fired (13)

(the magazine selector can be moved to either the full right or full left position to block the corresponding magazine if you choose to fire from only one magazine), check that there is no one in front of the firing line and that there is a sufficient down range back stop to contain the fired projectiles.

With the range safe, place the butt of the UTS-15 snugly to your shoulder (14)

slide the action to the full forward locked position, rotate the safety to the fire position and commence firing.



The action will automatically release when the shell is fired; the action should then be moved fully rearward in a positive manner to expend the spent cartridge and have a new live round loaded onto the shell loading ramp (15).

UTS15

Sliding the action back into the full forward and locked position loads the new round and completes the loading cycle. Be sure the action is fully forward and locked before pulling the trigger. If the trigger is pulled before the action is fully forward and locked the hammer will fall, but the firing pin can not reach the shell's primer, this is a key safety feature of the UTS-15 to insure that a shell can not be fired until the action is fully closed and locked. Inexperienced shooters, in an attempt to load and fire rapidly will often pull the trigger before the gun is locked and then think that either the shell is a dud or something is wrong with the gun. To rapidly fire the UTS-15 takes practice, so go slowly at first making a conscious effort to positively pump the action fully rearward, then forward into the locked position before pulling the trigger. After repeated practice, pumping the UTS-15 can become a motor reflex, but only time and work on the range can develop this skill.



Unloading

When you have finished firing the UTS-15 if a shell remains in either magazine, place the safety in the safe position, remove the gun from your shoulder and while keeping it pointed down range depress the bolt release button and cycle the remaining shells through the action.

Once the last live shell has been ejected leave the action open, raise the upper stock and visually confirm that no shells remain in the magazines tubes, then visually confirm that no shell remains in the chamber of the barrel (16).



The UTS-15 is now ready for cleaning.

Cleaning

It is not necessary to fully disassemble the UTS-15 to clean it, but field stripping is advised so that proper lubrication can be applied to keep the action running smoothly.

UTS15



To field strip the UTS-15, leave the upper stock in the raised position, unscrew and remove the barrel retaining cap (17).

Then slide the barrel / magazine assembly forward and lift off (18).



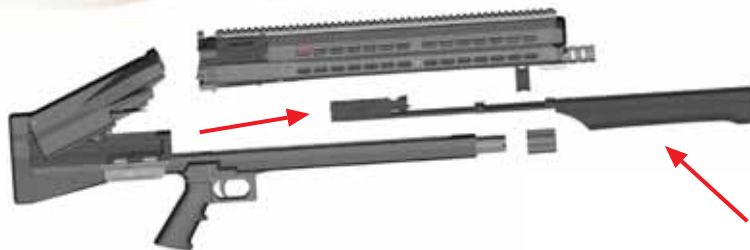

With the barrel / magazine assembly removed, slide the fore-end and bolt carriage assembly forward and off (19),

while being conscious that the bolt when free of the receiver can be lifted off the bolt carriage (20).

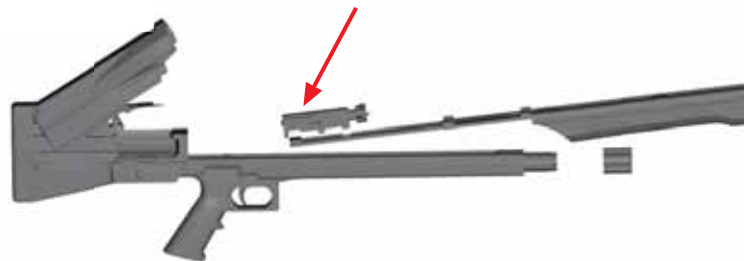

You will now have four parts: the barrel / magazine assembly, lower stock and receiver assembly, bolt carriage / fore-end assembly and bolt. Clean the barrel with gun solvent and finish with a lightly oiled patch. The inside of the receiver can be wiped clean, but oil should not be used. For best operation a small amount of dry graphite powder provides the best lubrication. Wiping the bolt head and shank with a cloth and a drop of gun oil on the bolt head shank is all that is necessary to keep the bolt working smoothly. Further disassembly will be discussed later in this manual, but in most cases this simple cleaning and lubricating procedure is all that is necessary.

Field Strip Reassembly

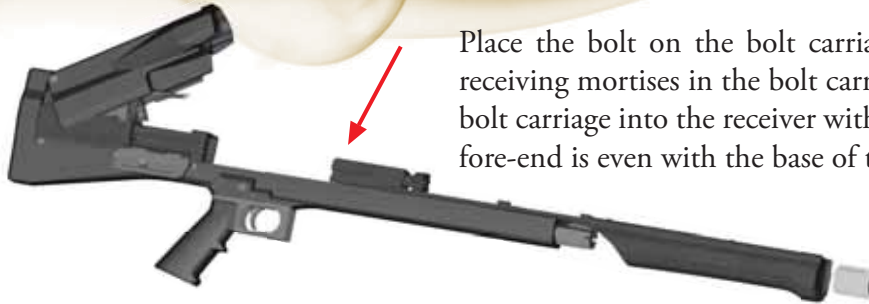

Place the bolt on the bolt carriage making sure it is fully down into the receiving mortises in the bolt carriage. With the upper stock raised, slide the bolt carriage into the receiver with the bolt release button depressed until the fore-end is even with the base of the barrel retaining pipe (21).

Now slide the barrel / magazine assembly into the receiver while making sure that the foot of the shell release slide is between the two bolt carriage extensions (22).



Press down firmly to make sure the barrel is fully mounted into the receiver then replace the barrel retaining cap making sure it is screwed down snugly. Close the upper stock, slide the action into the forward and locked position, then close the ejection port door.

Complete disassembly

Field strip the UTS-15 (see section on field stripping).

Bolt – With a drift punch remove the lateral pin (23) in the lower rear of the bolt while depressing the firing pin forward to keep the firing pin spring captured when the lateral pin is removed.



Remove the firing pin and firing pin spring (24).





Lift out the bolt head retaining pin. Slide out the bolt head and bolt head spring (25).

Place the bolt head in a vice or similar type holding fixture and drive out the extractor retaining pin with a drift punch, being conscious of the extractor spring underneath the extractor. The bolt is now completely disassembled into its component parts.



Receiver – remove C clips from the receiver retaining pins and upper stock hinge pin (26).

Remove receiver and upper stock retaining pins with a drift punch then lift and remove upper stock. Remove butt plate retaining pin (27) with a drift punch and slide butt plate out of the lower stock assembly.



Rotate receiver out of lower stock (28) and unhinge trigger linkage from trigger.





With the receiver now free of the lower stock place the receiver on a surface in such a manner that the rear gearbox retaining pin (29) can be removed with a drift punch.

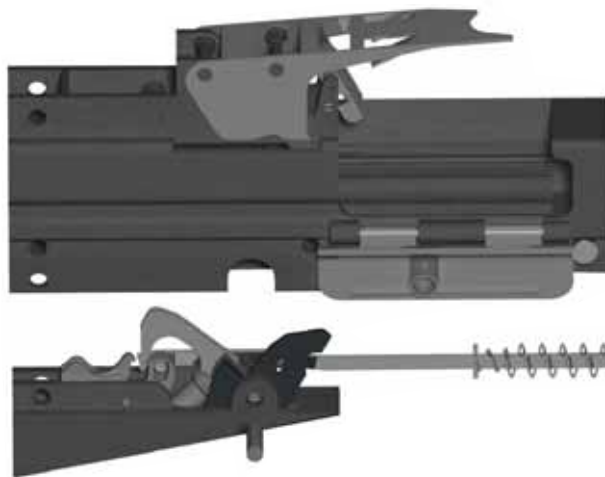

The front gearbox retaining pin can now be driven from left to right with a drift punch only $\frac{1}{4}$ " (30) to allow the gear box assembly to be dropped out of the bottom of the receiver while still retaining the component parts in the gear-box assembly.

The trigger linkage will fall free as the gearbox is removed (31).



The gear box can be further disassembled by removing the remaining gear box retaining pin which will free the hammer, hammer spring & plunger and bolt release (32).





The sear / secondary sear assembly can be removed from the gearbox housing by pushing out the sear pivot pin (33)

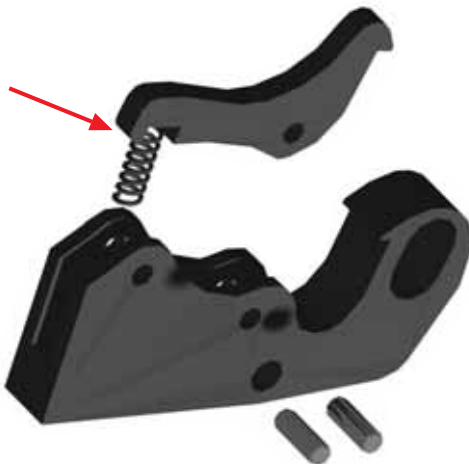

with a drift punch. The secondary sear can then be removed by driving out the secondary sear pivot pin (34)

while being conscious of the secondary sear spring retained underneath.

The loading mechanism of the receiver can now be addressed. First remove the C clips from the mousetrap spring retaining pin (35).



With the receiver held in a vice or similar holding fixture, hold the mousetrap spring down by placing a block of wood or similar material on the spring coils while the mousetrap spring retaining pin is removed with a drift punch. Remove the C clips from the mousetrap spoon pivot and forward pin (36) and remove pins from assembly.

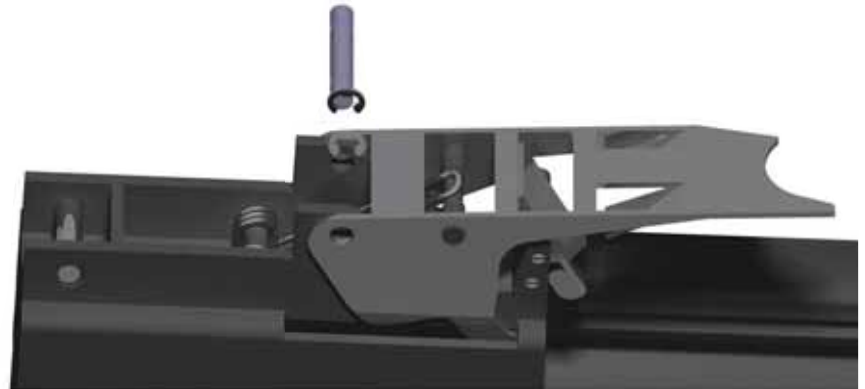



The mousetrap trigger plate and spring is held in place with a headless screw, with a similar spring bearing screw directly below (37).

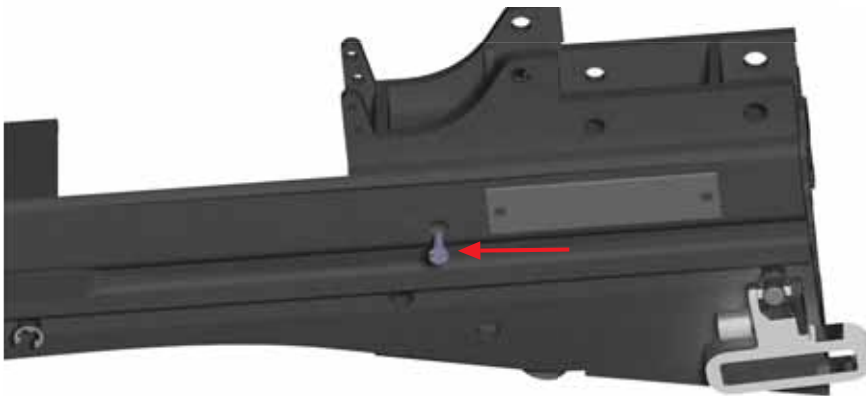

Carefully remove these two screws to complete the disassembly of the receiver loading mechanisms. Unscrew the ejector spring retaining screw on the left side of the receiver (38).

With the ejector spring retaining screw removed the ejector spring and pin (39)



may fall free or can be pushed out of the receiver with a thin screw driver or wire. Carefully drive the ejection port door retaining pin (40) out of the receiver being conscious of the ejection port door spring; this completes the disassembly of the receiver.

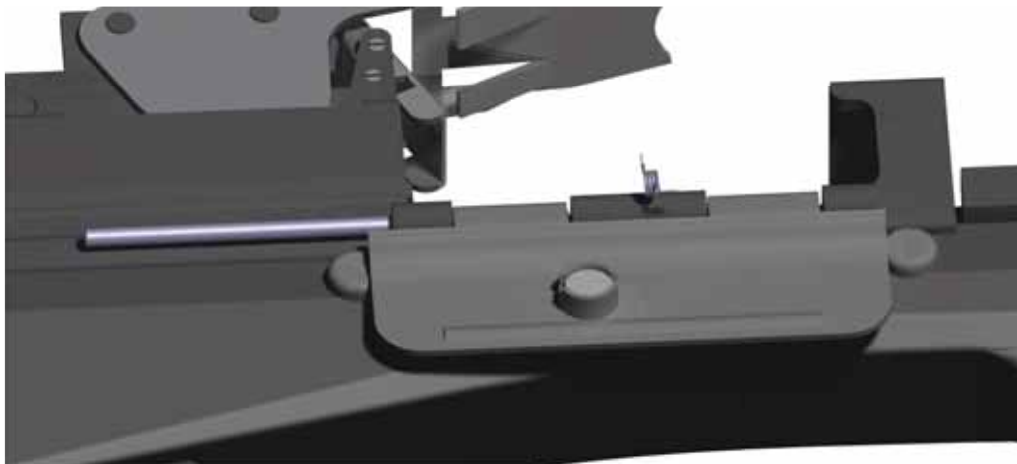

UTS15



Lower stock – remove the safety spring retaining screw (41)



Rotate the safety a little over 90° until the machined clearance flat on the safety is over the trigger bar and slide safety out of the stock(43)



Remove the C clips from the trigger retaining pin, push out the pin and lift the trigger out of the stock (43 A).



UTS15

If your UTS-15 is equipped with a tactical laser / spotlight unit the unit can be completely removed by unplugging the wiring just forward of the switch (44).



If the switch needs to be removed the rotary switch (45) can be unscrewed and the switch body pulled free.



Barrel / magazine assembly - Remove the magazine cap (46) by unscrewing the two forward caps screws

being conscious that the magazine cap retains the magazine springs.

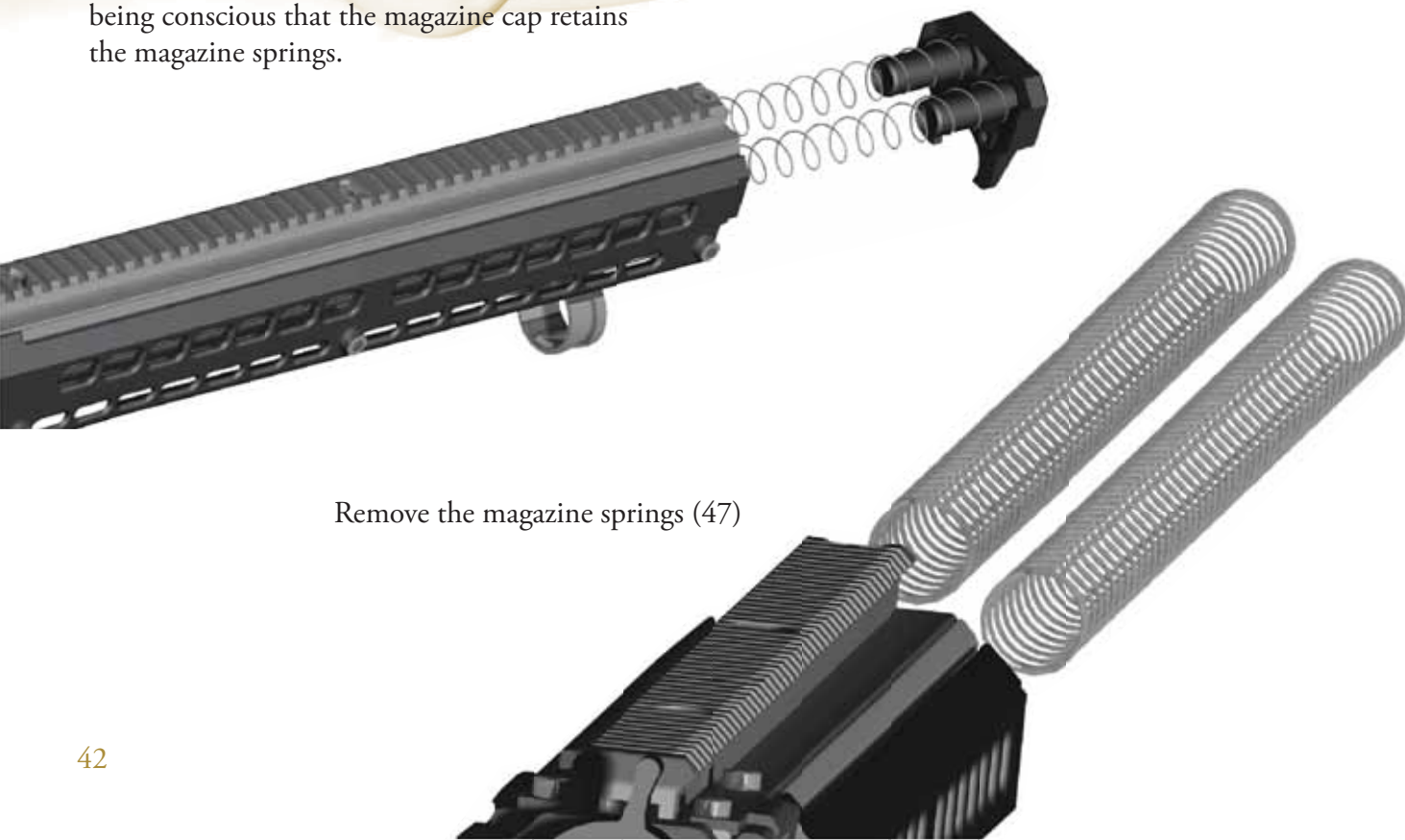

Remove the magazine springs (47)

and magazine followers (48).



Remove the three side cover screws on the right side and the two side cover screws and sling swivel screw on the left side (49) and lift off side covers.

UTS15

Unscrews the three top
rail screws (50)

and lift off top rail /
magazines, monobloc
subassembly (51)





the three magazine supports (52) can now be lifted off the barrel.



Remove the two shell release slide screws (53)

with their washers and tensions springs and lift off the shell release slide (54).



This will also free the top rail from the monobloc and allow the magazine tubes to be removed from the monobloc as well (55 A).



Remove the shell stop full right or full left position.
Right behind the shell stop there is a retaining screw
which connects the monoblock to the shell stop.
First unscrew the shell stop retaining screw then
unscrew the shell stop screw. (55 B)

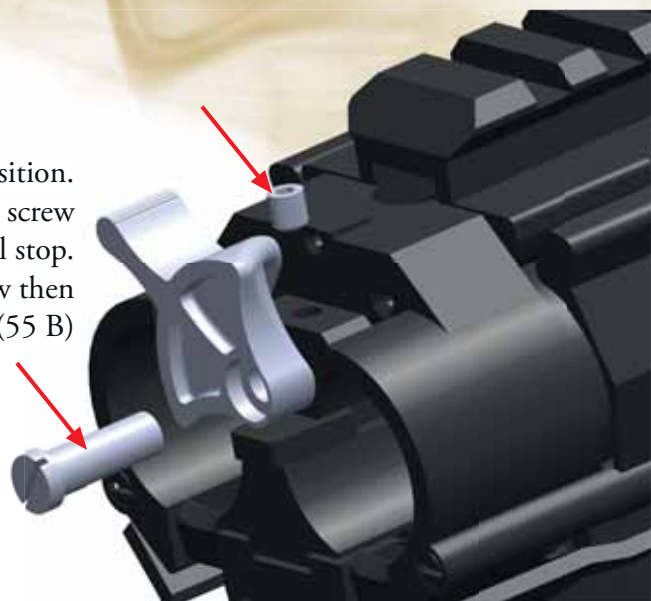
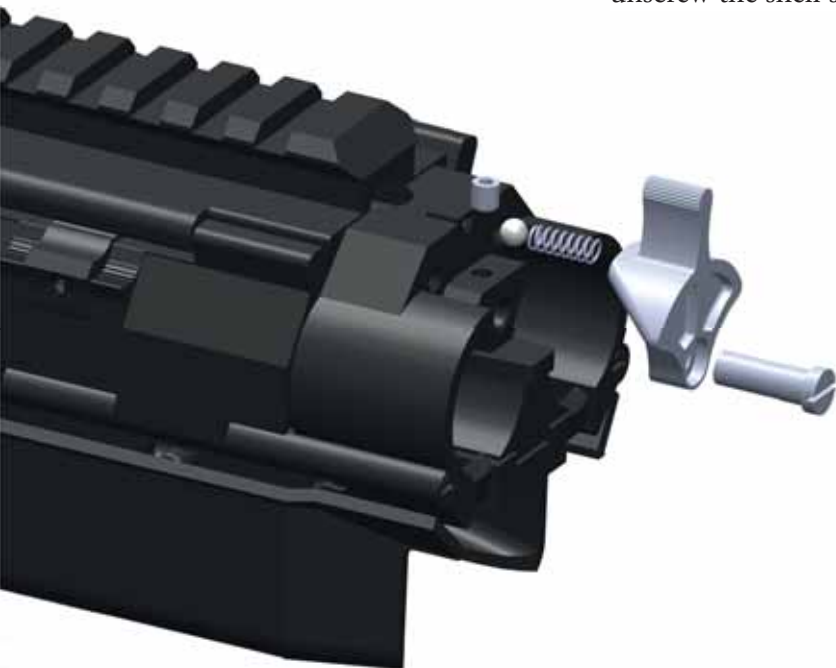

being conscious of the spring and
detent bearing housed in the shell
stop(56).

Remove the two screws holding the shell gate cap (57)

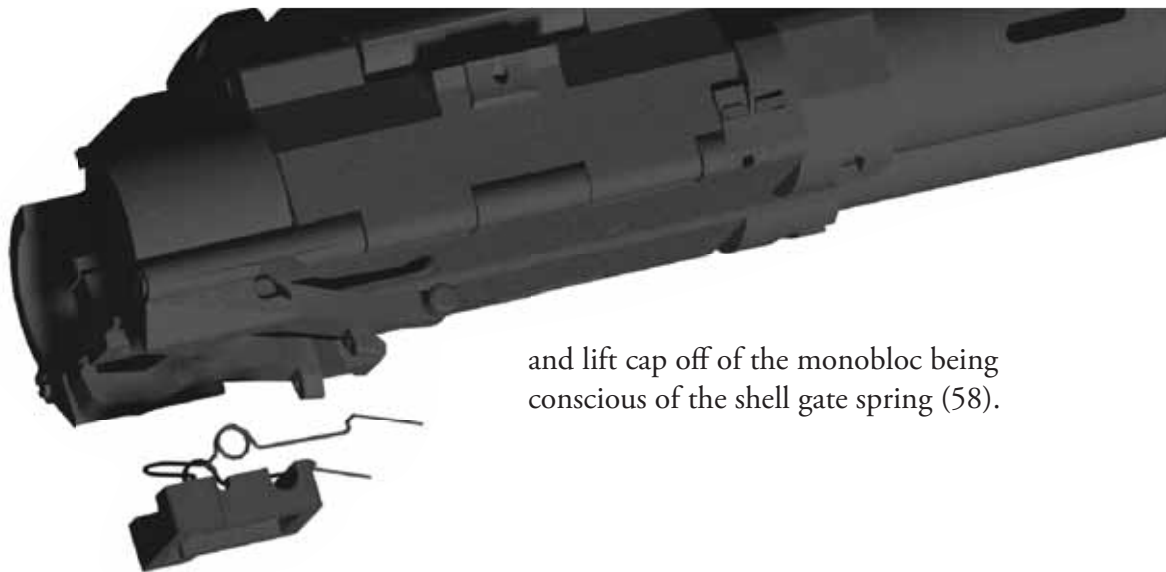

and lift cap off of the monobloc being conscious of the shell gate spring (58).

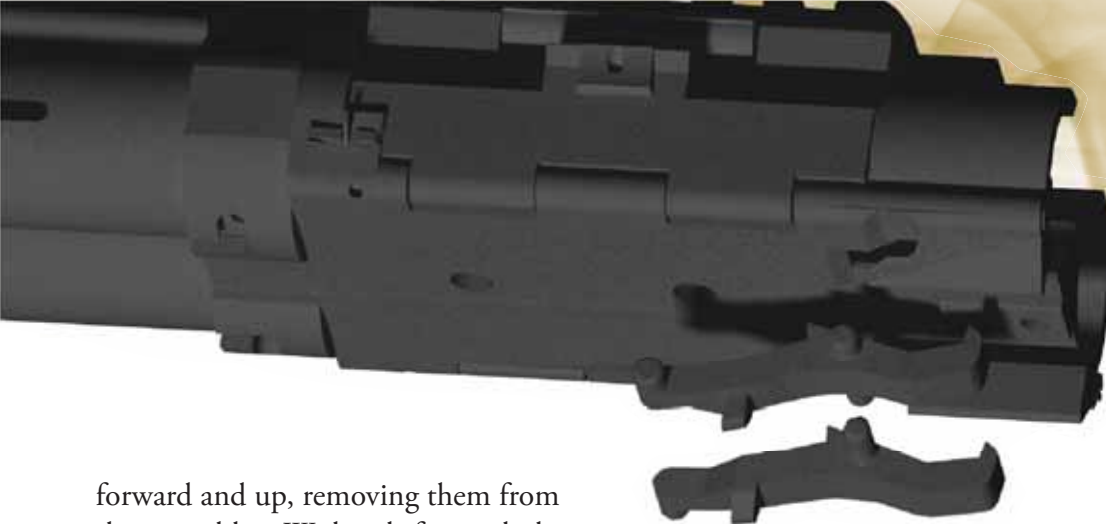

Slide the shell gates (59)

forward and up, removing them from the monobloc. With a drift punch drive out the shell catch pivot pin (60) and remove shell catch and shell catch spring from the monobloc. Drive the loading port door hinge pin (61)

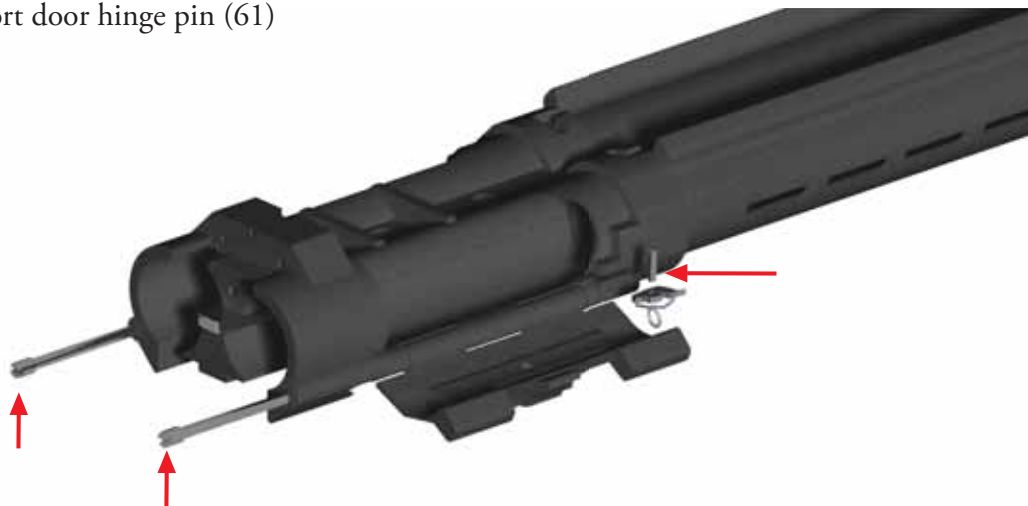

out of the monobloc from front to rear with a drift punch and lift loading port doors free.



Remove loading port door latch retaining screw (62)



being conscious of the loading port door latch spring underneath. Unscrew the interrupter retaining screw (63) from the monoblock

and slide interrupter (64) out of monoblock.

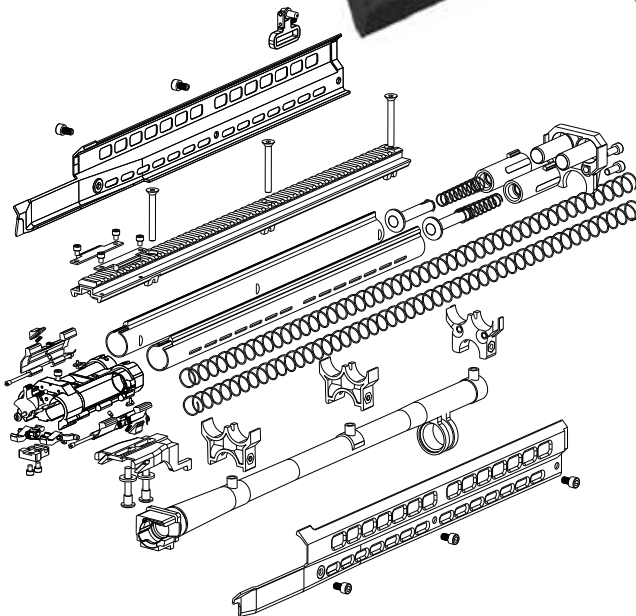

This completes the entire disassembly of the UTS-15.

Assembly – The UTS-15 is simple and robust by design and does not require a skilled gunsmith for correct assembly. However, in some areas special tools and fixtures greatly contribute to the ease of assembly. Professional service personnel should contact UTAS Technical Services for the availability of special tools, fixtures and training videos.



UTS15

UTS-15 Pump Action Shotgun
Parts of the UTS-15

Part Listing For Model: UTS15 Pump-action

UTS15

VIEW	DESCRIPTION	QTY
1	FRONT MAGAZINE CAP	1
2	FRONT MAGAZINE CAP SCREWS	2
3	MAGAZINE FOLLOWER BODY LEFT & RIGHT	2
4	MAGAZINE FOLLOWER PLUNGER	2
5	MAGAZINE FOLLOWER SPRING	2
6	RIGHT MAGAZINE TUBE	1
7	LEFT MAGAZINE TUBE	1
8	MAGAZINE TUBE SPRING	2
9	MONOBLOCK BODY	1
10	SHELL RELEASE PLATE	1
11	SHELL RELEASE PLATE SCREW	2
12	RIGHT SHELL RELEASE GATE	1
13	LEFT SHELL RELEASE GATE	1
14	SHELL RELEASE GATE SPRING	1
15	SHELL FEED GATE CAP	1
16	SHELL FEED GATE SCREW	2
17	INTERRUPTER	1
18	INTERRUPTER SCREW	1
19	SHELL STOP	1
20	SHELL STOP SCREW	1
21	SHELL STOP SPRING	1
22	SHELL STOP BALL 4 MM	1
23	RIGHT LOADING PORT DOOR	1
24	LEFT LOADING PORT DOOR	1
25	LOADING PORT HINGE PIN	2
26	TOP RAIL	1
27	LOADING PORT DOOR SCREW	4
28	TOP RAIL SCREW	3
29	FRONT MAGAZINE SUPPORT	1
30	MIDDLE & REAR MAGAZINE SUPPORT	2
31	RIGHT SIDE COVER	1
32	LEFT SIDE COVER	1
33	SIDE COVER SCREW	5
34	SIDE COVER SCREW WITH HOLE	1
35	BARREL	1
36	BARREL EXTENSION	1
37	EXTENDED CHOKE TUBE	1
38	BARREL HANGER	1
39	BARREL STUDS	3
40	FORE-END	1
41	FORE-END SCREW	4
42	BOLT CARRIAGE	1
43	BOLT BODY	1
44	BOLT HEAD	1
45	FIRING PIN	1
46	FIRING PIN SPRING	1
47	BOLT HEAD SPRING	1
48	BOLT HEAD PIN	1
49	FIRING PIN RETAINING PIN	1
50	BOLT WHEEL	1
51	BOLT WHEEL SCREW	1
52	EXTRACTOR	1

VIEW	DESCRIPTION	QTY
53	EXTRACTOR PIN	1
54	EXTRACTOR SPRING	1
55	MAGAZINE CAP	1
56	MAGAZINE CAP SPRING	1
57	LOWER STOCK	1
58	TRIGGER GUARD	1
59	LOWER STOCK MAGAZINE TUBE	1
60	TRIGGER	1
61	TRIGGER PIN	1
62	SAFETY	1
63	SAFETY BALL 3 MM	1
64	SAFETY SPRING	1
65	PISTOL GRIP	1
66	PISTOL GRIP SCREW	1
67	TRIGGER GUARD SCREW	2
68	GEAR BOX BODY	1
69	HAMMER	1
70	BOLT RELEASE	1
71	HAMMER/BOLT RELEASE PIN	1
72	BOLT RELEASE SPRING	1
73	HAMMER SPRING	1
74	HAMMER SPRING PLUNGER	1
75	SEAR	1
76	SECONDARY SEAR	1
77	SEAR PIN	1
78	SECONDARY SEAR PIN	1
79	SECONDARY SEAR RETAINING PIN	1
80	SECONDARY SEAR SPRING	1
81	TRIGGER LINKAGE	1
82	HAMMER SPRING HOUSING	1
83	TRIGGER LINKAGE SPRING	1
84	RECEIVER	1
85	RECEIVER PLATE	1
86	EJECTION PORT DOOR	1
87	EJECTION PORT DOOR MAGNET	1
88	EJECTION PORT DOOR SPRING	1
89	EJECTION PORT HINGE PIN	1
90	MOUSE TRAP PIN	1
91	MOUSE TRAP SPOON	1
92	MOUSE TRAP FORWARD PIN	1
93	MOUSE TRAP SPRING	1
94	MOUSE TRAP SPRING RETAINING PIN	1
95	MOUSE TRAP TRIGGER PLATE	1
96	MOUSE TRAP TRIGGER PLATE PIN	1
97	MOUSE TRAP TRIGGER PLATE LOWER PIN	1
98	MOUSE TRAP TRIGGER PLATE SPRING	1
99	EJECTOR PIN	1
100	EJECTION PORT MAGNET HOUSING	1
101	EJECTOR SPRING RETAINING SCREW	1
102	EJECTOR SPRING	1
103	RECEIVER RETAINING PINS	1
104	MIDDLE RECEIVER RETAINING PIN	2

VIEW	DESCRIPTION	QTY
105	REAR GEAR BOX PIN	1
106	BUTT PLATE	1
107	RECOIL PAD	1
108	UPPER RETAINING PIN	1
109	UPPER STOCK	1
110	UPPER STOCK RETAINING PIN	1
111	SLING SWIVELS	2
112	FRONT SIGHT	1
113	SIGHT PIN	1
114	FRONT SIGHT CLAMP	1
115	FRONT SIGHT CLAMP SCREW	2
116	SET SCREW	1
117	REAR SIGHT	1
118	REAR SIGHT SPRING	1
119	REAR SIGHT APERTURE	1
120	WINDAGE SCREW	1
121	WINDAGE ADJUSTMENT KNOB	1
122	WINDAGE KNOB PIN	1
123	REAR SIGHT CLAMP SCREW	2
124	REAR SIGHT CLAMP	1
125	7.5" BARREL EXTENSION	1
126	TAKE DOWN TOOL	1
127	WINDAGE ADJUSTMENT KNOB SPRING	1
128	WINDAGE ADJUSTMENT KNOB BALL 3MM	1
129	LASER / FLASHLIGHT UNIT	1
130	FLASHLIGHT LENS	1
131	C CLIPS (3 MM)	2
132	C CLIPS (4 MM)	6
133	C CLIPS (5 MM)	4
134	O-RING	1
135	SAFETY SCREW	1
136	LEFT & RIGHT MAGAZINE TUBE RIVETS	4
137	SHELL RELEASE PLATE SPRING	2
138	SHELL RELEASE PLATE SCREW FLAT WASHER	2
139	PISTOL GRIP SCREW SERRATED WASHER	1
140	TRIGGER GUARD SCREW SERRATED WASHER	2
141	MONOBLOCK BODY EXTRACTOR	2
142	MONOBLOCK BODY EXTRACTOR SPRING	2
143	MONOBLOCK BODY EXTRACTOR PIN	2
144	LOADING PORT DOOR LOCK SLIDE	2
145	LOADING PORT DOOR LOCK SLIDE SPRING	2
146	LOADING PORT DOOR LOCK SLIDE SCREW	2
148	EXTENDED CHOKE TUBE CYLINDER SHORT	1
149	LASER / FLASHLIGHT SWITCH COVER	1
150	LOWER RECEIVER MAGAZINE TUBE LASER CAP	1
151	MAGAZINE CAP PIN	1
154	RED FLASHLIGHT UNIT	1
155	GREEN FLASHLIGHT UNIT	1
163	SHELL STOP RETAINING SCREW	1
164	LASER / FLASHLIGHT SWITCH HOLE PLUG	2
165	LASER / FLASHLIGHT TRIPLE SWITCH COVER	1

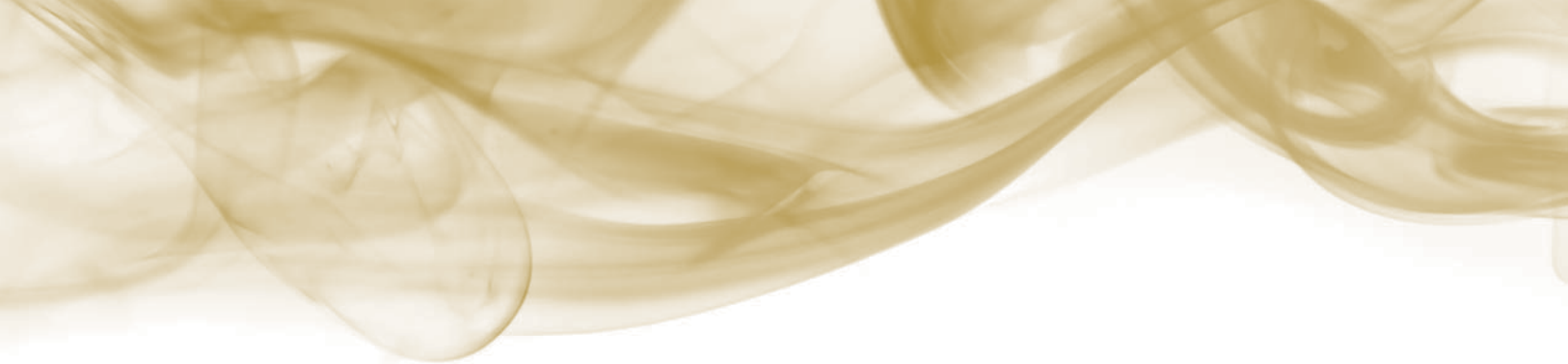

UTS15





1505 Cox Road
Cocoa FL 32926
Phone: 1-800-515-9983
Fax: 321-631-1169

WWW.KELTECWEAPONS.COM



SAFETY, INSTRUCTION and PARTS MANUAL



 Warning: Read this manual carefully before loading or using the KSG™.

TABLE OF CONTENTS

A.	Safety Information and Warnings.....	2
B.	Overview.....	5
	Description.....	5
	Nomenclature.....	5
	Specifications.....	5
	Ammunition.....	6
	Sling Mounting.....	6
C.	Operating Instructions.....	7
	Safety.....	7
	Loading Magazines.....	7
	Chambering from Magazine.....	8
	Manual Chamber Loading.....	8
	Firing.....	8
	Unloading.....	10
D.	Disassembly.....	10
	Removal of Grip Assembly.....	13
	Removal of the Stock.....	14
	Separation of the Barrel and Receiver Assemblies.....	15
E.	Assembly.....	16
	Joining of the Barrel and Receiver Assemblies.....	16
	Insertion of the Bolt.....	18
	Insertion of the Stock.....	19
	Attaching the Grip Assembly.....	19
F.	Cleaning and Maintenance.....	20
	Maintenance.....	20
	Lubrication.....	20
	Troubleshooting.....	21
G.	Exploded View and Parts List.....	11
H.	Service, Repair and Limited Lifetime Warranty.....	22

A. SAFETY INFORMATION AND WARNINGS

STATEMENT OF LIABILITY

This firearm may be classified as a dangerous weapon and is surrendered by KEL-TEC CNC INDUSTRIES INC. with the understanding that the purchaser assumes all liability resulting from unsafe handling or any action that constitutes a violation of any applicable laws or regulations. Firearms can cause serious injury and death. **Safety must be the prime consideration of anyone who handles firearms. Always treat a firearm as though it were loaded. Always keep the muzzle pointed in a safe direction.** In owning a firearm, you are responsible for the firearm's safety and security. **Always secure firearms from children.**



READ THESE INSTRUCTIONS AND WARNINGS CAREFULLY, BE SURE YOU UNDERSTAND THESE INSTRUCTIONS AND WARNINGS BEFORE USING THIS FIREARM.

This SAFETY, INSTRUCTION & PARTS MANUAL should always accompany this firearm and be transferred with it upon change of ownership or when the firearm is loaned or presented to another person. A copy of the SAFETY, INSTRUCTION & PARTS MANUAL is available FREE upon request and can also be downloaded from the internet at: <http://www.keltecweapons.com>

READ AND CAREFULLY FOLLOW THESE WARNINGS AND INSTRUCTIONS

These warnings and instructions are provided to assure the safe functioning of the firearm. Failure to heed these instructions may result in improper functioning and serious injury.

Kel-Tec® firearms are designed to function reliably with proper care and knowledgeable use. Do not use your firearm unless you fully understand these instructions, and the safe operation of your firearm.

Only safe gun-handling habits will ensure the safe use of your firearm. This is your responsibility. Accidents are the result of violating the rules of safe gun handling noted below and common sense.

Before handling a firearm, understand its operation.

Never accept or pick up a firearm without checking the magazine and the chamber to assure the weapon is empty. Do not trust the extractor to clear the chamber; always look and feel.

Always make sure the **muzzle is pointed in a safe direction at all times**. Never point a firearm at anyone or anything you do not intend to shoot.

Ensure the barrel is free of obstructions prior to firing. Open the action and clear the firearm of all ammunition before checking the barrel of the **unloaded** firearm.

Keep your firearm unloaded when not in use. Never keep a loaded firearm in the home or vehicle. Never store a firearm with a cartridge in the chamber. Never store firearms and ammunition together, keep them locked up and away from children.

Never touch the trigger when working the action.

Never alter any components of your firearm.

Never take medications, drugs, or alcohol when handling firearms.

Never load or unload a firearm without assuring the muzzle is pointed in a safe direction.

Never load a firearm except immediately before shooting.

SAFE GUN HANDLING IS YOUR RESPONSIBILITY



Discharging firearms in poorly ventilated areas, cleaning firearms, or handling ammunition may result in exposure to lead and other substances known to cause birth defects, reproductive harm, and other serious physical injury. Have adequate ventilation at all times. Wash hands thoroughly after exposure.

Never discharge a firearm without proper shooting glasses and ear protection. Never shoot at any water surface or any surface where a ricochet can occur.

Never shoot until you are sure of your backstop and what lies beyond it.

If the gun does not discharge after pulling the trigger, do not change the weapon's direction for at least 30 seconds; the weapon could be having a "hang fire", and the cartridge could go off when you do not expect it. After waiting 30 seconds, remove the magazine and remove the unfired case, while keeping the firearm pointed in a safe direction.

Always be aware of other people so that they cannot accidentally walk into the line of fire. When firing on a target range, be alert and follow the range officer's commands. Never cross obstacles such as fences or streams with a loaded firearm.

Do not allow a firearm to be used by individuals who do not understand its safe operation and the rules of safe gun handling.



WARNING: After firing several rounds, the exterior metal parts of the firearm get VERY hot and can cause severe burns if touched.

Be sure all accessories are compatible with the firearm and that the accessories do not interfere with safe operation of the firearm.

When transporting your firearm, be sure your firearm is unloaded and on SAFE.

This weapon passes Industry Standards for drop-test safety; this does not guarantee the weapon may not accidentally discharge upon being dropped while loaded.

If you do not understand how to operate any of our products or have any questions about their safe handling, please write, call, or email us at:

KEL-TEC CNC INDUSTRIES INC

1505 Cox Road
Cocoa, FL 32926

Telephone Number: 321-631-0068

Toll free: 1-800-515-9983

Hours: M-F 9am-3pm EST (excluding holidays)

Website: <http://www.keltecweapons.com>

Email: customerservice@kel-tec-cnc.com

B. OVERVIEW

Description

The KSG™ is a dual-magazine select-feed 12-gauge pump action shotgun. The bullpup dual-magazine select-feed design provides the operator with a more compact layout, increased total capacity, and the option to rapidly switch between two magazines of ammunition.

The KSG™ features positive extraction and ejection, allowing it to be reliably fired in any shooting orientation. Loading and ejection are combined into a single port rearward of the grip assembly under the shotgun, enabling the KSG™ to be fired from both the dominant and non-dominant side.

Two integral MIL-STD-1913 Picatinny rails, located above the barrel and on the forend, come standard with the KSG™ for mounting accessories. Unloaded, the KSG™ maintains a center of gravity over the grip assembly to facilitate ease of handling.

Nomenclature

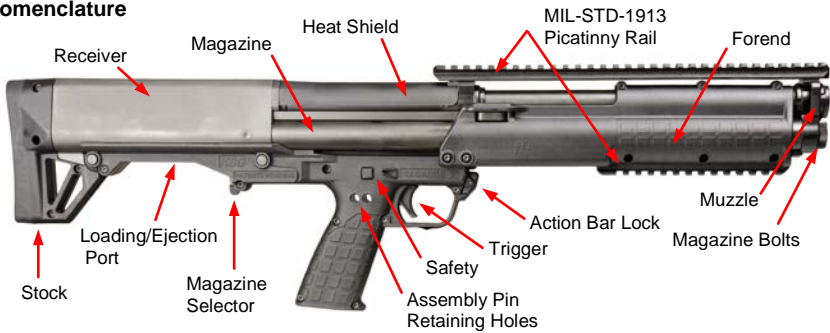

Figure B-1: Side-View

Specifications

Design Features	
Operating System	Pump Action
Gauge	12
Capacity	6+6+1 dual magazines, 3" shells
Chamber	12-gauge 3.00" (76 mm)
Barrel Length	18.50" (470 mm)
Length of Pull	13.0" (330 mm)
Forend Travel	4.1" (104 mm)
Accessory Mount	MIL-STD-1913 Picatinny Rail

Dimensions and Weight	
Total Length	26.1" (664mm)
Total Width	2.2" (56 mm)
Total Height	8.0" (204 mm)
Width of Grip	1.2" (30 mm)
Width of Forend	2.1" (54 mm)
Width of Stock	2.1" (54 mm)
Weight	6.9 lbs (3.1 kg)

Ammunition

The KSG™ is chambered for 12-gauge 3" shells and may safely fire both lead and steel shot. Shells 2-3/4" and shorter are also safe to fire, but anything shorter than 2-3/4" should be thoroughly tested for reliable feeding and ejection. For reference, the chamber gauge and length is indicated on the grip of the shotgun.



WARNING: ALWAYS USE SHELLS OF THE CORRECT GAUGE AND LENGTH OR SHORTER. DO NOT USE NON-STANDARD AMMUNITION OR SHELLS WITH PRESSURES EXCEEDING SAAMI STANDARDS. FAILURE TO FOLLOW THIS WARNING MAY RESULT IN SERIOUS INJURY OR DEATH AND DAMAGE TO YOUR FIREARM.

Only use commercially available US-manufactured ammunition that meets SAAMI established standards. Inspect your ammunition to make sure it is clean, dry, and in good condition. Never use non-standard, reloaded or damaged shells. Any other ammunition is considered non-standard and its use may void the warranty on this firearm.

Kel-Tec™ firearms are manufactured from high quality materials. They will provide a lifetime of service if properly maintained. However, all warranties, expressed or implied, are voided and Kel-Tec will not be liable for property damage or personal injury and consequential damages, if faulty, non-standard, or reloaded ammunition is used in any Kel-Tec™ firearm.

Sling Mounting

The KSG™ comes equipped with forward attachment points on the left and right sides of the barrel assembly as well as a single rear attachment slot in the stock.



Figure B-2: KSG™ Equipped with Kel-Tec™ Sling

The different sling attachment points on the KSG™ should be used to mount the included 1¼" wide nylon sling but will also accommodate aftermarket slings of the same width.

C. OPERATING INSTRUCTIONS

Safety

The KSG™ features a cross-bolt safety located behind the trigger on the grip assembly. When the safety is activated, the cross-bolt blocks the sear from releasing and prevents the trigger from being pulled. Please note that the safety will not engage unless the hammer is cocked.

For right-handed users, the safety is generally pressed with the right thumb until a noticeable “click” is heard and the red letter “F” is visible on the safety. The safety is color coded and labeled to enhance visibility and hasten safety assessment.



White “S” for SAFE



Red “F” for FIRE



WARNING: NEVER TOTALLY RELY ON YOUR MECHANICAL SAFETY AS IT CAN FAIL OR UNINTENTIONALLY BE DISENGAGED. YOUR MECHANICAL SAFETY IS NOT A SUBSTITUTE FOR SAFE GUN HANDLING PRACTICES.

Loading Magazines

1. Ensure your muzzle is pointed in a safe direction before loading.
2. Engage the safety by ensuring the white “S” is visible.
3. Ensure the forend is locked forward and not in the rearmost position.
4. Place magazine selector to the positions shown in *Figure C-1* depending on desired loading configuration. The magazine selector indicates which magazine is selected for loading by “pointing” to the active magazine. For example: if the magazine selector is pointing left, the left magazine is available for loading. The magazine selector may also be placed in the middle position, which blocks both magazine tubes from loading and feeding.



Figure C-1: Magazine Selector Orientations

5. With thumb on the base of the round, insert the round into the loading/ejection port and slide the round into the magazine using your thumb as shown in *Figure C-2*.



Figure C-2: Loading a Shell into the Magazine Tube

Chambering from Magazine

1. Ensure the magazine selector is oriented to feed from the desired magazine tube.
2. Press down on the action bar lock and maintain downward pressure to unlock forend.
3. Cycle the forend fully rearward and then fully forward to chamber a round.

CAUTION: DO NOT HOLD THE FOREND BEHIND THE PICATINNY RAIL. DOING SO WILL SHORT STROKE THE ACTION AND PINCH YOUR HAND.



Manual Chamber Loading

The procedure for loading a shell directly into the chamber of the KSG™ is different than most other shotguns because of the combined loading and ejection port. To load a shell into the chamber of the KSG™, use the following procedure as a guideline.

1. Ensure your muzzle is pointed in a safe direction before loading.
2. Engage the safety by ensuring the white “S” is visible.
3. Press down the action bar lock to unlock forend.
4. Slide the forend so that it is about a 1/2” from the rearmost position to prevent the lifters from elevating and blocking access to the chamber.
5. Place shell in chamber and slide the forend forward to chamber inserted shell.

Firing

1. Load a shell into the chamber of the KSG™ manually or from the magazine.
2. Aim at the target, taking notice of the target's backdrop.
3. Disengage the safety, taking notice of the red letter “F” that is visible on the safety.
4. Place trigger finger into trigger guard.
5. When the trigger is pressed, the KSG™ will fire. Cycle the forend to eject the empty case and feed a new round, if a loaded magazine tube is selected.

Unloading

1. Ensure your muzzle is pointed in a safe direction before unloading.
2. Ensure the forend is locked in the forward position.
3. Engage the safety by ensuring the white “S” is visible.
4. Press magazine selector to one side (either side).
5. Rotate the KSG-331-CTG OUT down to release one or more shells in the selected magazine tube. NOTE: Shells will eject with some force from the magazine tube.
6. Magazine is empty when the white magazine follower is visible from the ejection port, as shown previously in *Figure C-1*.
7. Switch the magazine selector to select the other magazine tube for unloading.
8. Repeat steps 5-6.
9. With the forend in its rearmost position, always visually and tactually check the chamber to confirm the firearm is unloaded.

D. DISASSEMBLY

For regular maintenance of the KSG™, it will be necessary that you become familiar with its disassembly. The following sections should be followed in sequential order and continued as needed depending on desired maintenance.



Figure D-1: KSG™ General Disassembly



WARNING: ALWAYS ENSURE THE KSG™ IS CLEAR OF ALL AMMUNITION BEFORE ATTEMPTING DISASSEMBLY. IF THE KSG™ HAS BEEN FIRED, WAIT A SUFFICIENT AMOUNT OF TIME FOR THE COMPONENTS TO COOL BEFORE ATTEMPTING DISASSEMBLY.

Removal of Grip Assembly

1. Place magazine selector to the center position.
2. Engage the safety by ensuring the white "S" is visible.
3. Remove the rear assembly pins adjacent to the ejection port located on the grip assembly and place them in the assembly pin retaining holes as shown in *Figure D-2*.



Figure D-2: Place Rear Assembly Pins in Retaining Holes

4. Remove the grip assembly by lifting the rear of the assembly directly upwards as shown in *Figure D-3*.



Figure D-3: Lift Grip Assembly Directly Upwards

Removal of the Stock

1. Grip the stock as shown in *Figure D-4* and pull rearward to remove.



Figure D-4: Pull Stock Rearward

2. Move the forend to its rearmost position to gain access to the bolt. The bolt should now be resting in the receiver of the KSG™ and can be easily removed by reaching in and lifting out the bolt as shown in *Figure D-5*.

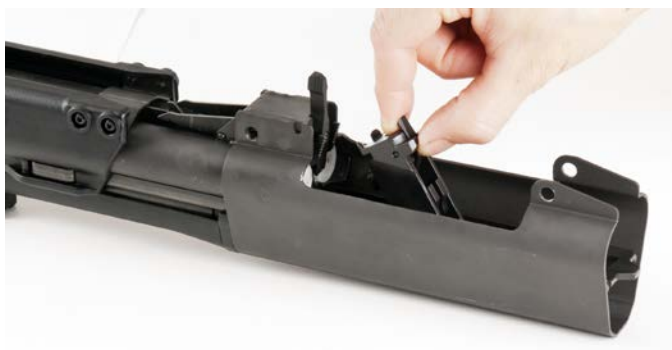

Figure D-5: Remove Bolt from Receiver

Kel-Tec KSG

118	BARREL	1
135	BARREL EXTENSION	1
136	BARREL NUT	1
137	BARREL RING	3
138	SIGHT BASE	1
139	PUMP BUFFER	1
140	MUZZLE PLATE	1
141	M3-20 SOCKET HEAD	1
142	PICATINNY	1
146	MAG BOLT	2
148	WAVY WASHER	2
154	MAG BOLT RETAINER CLIP	2
170	BOLT	1
172	EXTRACTOR	1
173	HEAT SHIELD	1
174	BOLT LOCK	1
175	FIRING PIN PIN	1
176	FIRING PIN	1
177	EXTRACTOR AXIS	1
178	EXTRACTOR SPRING	1
179	BOLT LOCK PIN	1
185	BOLT CARRIER	1
209	FRAME PIN	2
210	M3-10 SOCKET HEAD	1
211	M3-16 SOCKET HEAD	17
212	M3 NUT	19
214	GRIP RIGHT	1
215	GRIP LEFT	1
216	TRIGGER	1
218	FOREND RIGHT	1
219	FOREND LEFT	1
220	HAMMER	1
221	HAMMER BAR	2
223	ACTION LOCK	1
224	SEAR BAR	1
225	SEAR	1
226R	HAMMER BAR PIN	2
227	SEAR CATCH	1
228	MAG STOP ACTUATOR	1
230	M4-6 BUTTON HEAD	4
232	M4-12 BUTTON HEAD	2
234	HAMMER SPRING	2
236	M3-25 SOCKET HEAD	1
237	M3-35 SOCKET HEAD	1
238	SAFETY	1
240	SAFETY SNAP	1
241	ACTION BAR SPRING	1

242	TRIGGER SPRING	1
243	SEAR SPRING	1
244	SEAR SPRING GUIDE	1
249	CAPTOR SPRING	2

252	LOCK BUTTON	1
253	LOCK BUTTON PIN	1
254	SEAR GUIDE PIN	1
256	TRIGGER AXIS	2
257	HAMMER AXIS	1
300B	RECEIVER GEN 2	1
310	MAG PLUG	2
311	MAG FOLLOWER	2

320	SELECTOR WASHER	1
322	SELECTOR SNAP	1
323	CTG STOP PIN	1
324	STOCK PIN	2
325	MAG SPRING	2
328	SELECTOR SNAP SPRING	1
330	CTG CATCH INNER	1
331	CTG CATCH OUTER	2
333	SELECTOR	1
334	CTG STOP ACTUATOR	1
336	ACTUATOR SPRING	1
338	CTG STOP SPRING	1
350	LIFTER AXIS	2
352	LIFTER	1
376	STOCK RIGHT	1
377	STOCK LEFT	1
380	BUTT PAD	1

NOTE:

Exploded view of weapon is for reference only.
Design is subject to change without notice.



REV #020714

Separation of the Barrel and Receiver Assemblies

The barrel assembly is secured to the receiver assembly via two slotted magazine bolts located on the front of the KSG™. To remove these assemblies, the magazine bolts must be unscrewed using an object with a flat edge such as a quarter or the rim of a spent shell casing.

1. Using your tool of choice, unscrew the magazine bolts at the same rate alternating between the two bolts a half-turn at a time. This procedure is illustrated in *Figure D-6*.



Figure D-6: Unscrew Magazine Bolts with Alternating 1/2 Turns

2. The KSG-334-CTG Stop Actuator must be pressed down for clearance as the barrel and receiver assemblies are separated, as shown in *Figures D-7 & D-8*.



Figure D-7: Press down CTG Stop Actuator and Slide Forend Away

3. With the KSG™ upside-down, simultaneously pull the barrel assembly and receiver assembly linearly apart as shown in *Figure D-9*.



Figure D-9: Pull Barrel Assembly Apart from Receiver Assembly

CAUTION: FURTHER DISASSEMBLY SHOULD ONLY BE PERFORMED BY A CERTIFIED GUNSMITH OR KEL-TEC CNC INC. ATTEMPTING FURTHER DISASSEMBLY COULD VOID YOUR WARRANTY.

E. ASSEMBLY

Joining of the Barrel and Receiver Assemblies

1. Ensure the bolt carrier is properly placed into the forend as shown in *Figure E-1*.



Figure E-1: Ensure Bolt Carrier is Locked into Forend

2. Orient the barrel and receiver assemblies as shown in *Figure E-2* and push the two units together, ensuring the magazine bolt screw threads seat into the magazine plug screw threads.



Figure E-2: Join Barrel Assembly to Receiver Assembly

3. When joining the Barrel and Receiver Assemblies, the CTG Stop Actuator may need to be pressed down for clearance under the Mag Stop Actuator. This process is illustrated in *Figure E-3*.

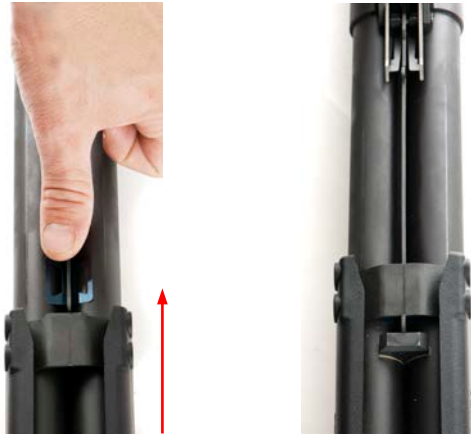

Figure E-3: Slide Forend over CTG Stop Actuator to Secure Assemblies

4. Using your tool of choice, screw the magazine bolts into the magazine plugs at the same rate, alternating between the two bolts a half-turn at a time until both bolts firmly resist further tightening. This must be done because the bolts screw into the same piece and will prematurely bind if one bolt is tightened faster than the other.
5. To ensure the two assemblies are properly joined, visually check that no gap exists between the barrel extension and receiver, as shown in *Figure E-4*. Additionally, attempt to pull the barrel and receiver assemblies apart and press them together, checking for any travel. If there is any travel or gap present, the magazine bolts are not fully tightened and steps 1-2 should be repeated.



Incorrect: Gap Present

Correct: No Gap Present

Figure E-4: Ensure No Gap Exists Between Assemblies

Insertion of the Bolt

1. Cycle the forend completely rearward before attempting to insert the bolt.
2. Insert the bolt onto the bolt carrier as shown in *Figure E-5*, first inserting the bolt on its side before rotating 90° to its upright position. The rear lip of the bolt should easily fit into the square cutout of the bolt carrier.

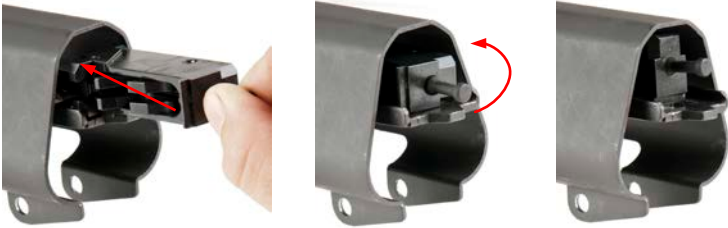

Figure E-5: Insert Bolt onto Bolt Carrier Sideways and Rotate 90°

3. Ensure the bolt is in the proper position by pushing the bolt completely forward. You can confirm this by checking to see if there is a gap between the mating surfaces shown in *Figure E-6*, which is composed of the bolt lip and bolt carrier cutout.
4. Move the forend completely forward to lock the bolt into place. You should hear a definitive “click” indicating the bolt is properly locking with the barrel extension.



Figure E-6: Push Bolt Fully Forward on Bolt Carrier

Insertion of the Stock

1. Ensure the forend is completely forward before attempting to insert the stock.
2. Insert the stock as shown in *Figure E-7* and ensure the lifter axes are in place. It may be helpful to lift up on the firing pin during assembly.

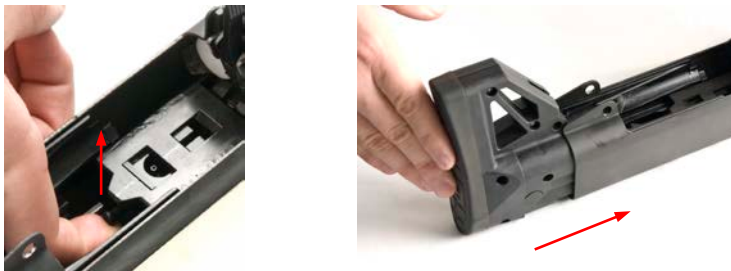

Figure E-7: Lift Firing Pin while Inserting Stock

Attaching the Grip Assembly

1. Place magazine selector to the center position.
2. Engage the safety by ensuring the white "S" is visible.
3. As shown in *Figure E-8*, ensure the forward part of the grip assembly is inserted under the grip catch and rotate the grip down.



Figure E-8: Move Forend Rearward and Insert Grip Assembly

5. Remove the assembly pins from their pin retaining holes and insert them into the assembly pin holes located on the grip assembly.
6. After the KSG™ is fully assembled, check the firearm for proper functioning by pressing down the action bar lock and cycling the action.

F. CLEANING AND MAINTENANCE

Maintenance

Your KSG™ is a precision instrument and will provide a lifetime of faithful service if it is properly cleaned and maintained. It is recommended that you clean your KSG™ after every shooting session or more frequently if needed. Be sure to unload your KSG™ (see *Unloading on pg. 8*) before performing any cleaning or maintenance procedures.

CAUTION: NEVER USE AUTOMOTIVE BRAKE CLEANER OR ANY SOLVENT NOT DESIGNED FOR POLYMER FIREARMS. DOING SO MAY DAMAGE THE FIREARM AND VOID YOUR WARRANTY.

1. Disassemble the KSG™ (see *Disassembly on pg. 9*).
2. Thoroughly clean all exterior sides of the bolt and receiver with solvent and brush.
3. Brush the barrel bore and chamber with a good powder removing solvent and bore brush. Wipe the areas clean with patches or a swab.
4. Using a small brush dipped in solvent, remove all deposits from around the breech of the barrel and barrel extension, as well as all adjacent areas that have been subjected to powder or primer residue.
5. Clean the magazine tubes with solvent and brush if needed.

Lubrication

After cleaning the entire gun, use a cloth to apply a light coating of high quality gun oil to all internal and exterior metal surfaces and wipe clean.

Manually cycle the action back and forth to check the function of the firearm. If any parts are damaged or badly worn or the firearm does not work correctly, the firearm should not be fired and should be returned to Kel-Tec for servicing immediately.



WARNING: DISCHARGING A FIREARM WITH OIL, GREASE, OR ANY OTHER MATERIAL EVEN PARTIALLY OBSTRUCTING THE BORE COULD RESULT IN SERIOUS INJURY OR DEATH AND SERIOUS DAMAGE TO YOUR FIREARM.

Troubleshooting

Proper functioning of your firearm is directly related to proper maintenance and care as well as the quality of ammunition you use. If in the unlikely circumstance your KSG™ malfunctions, we have included a list of several suggested remedies below.

If the KSG™ Fails to Fire: You may be experiencing a misfire and should point the barrel of the KSG™ in a safe direction, engage the safety by ensuring the white "S" is visible, and wait at least 30 seconds before fully cycling the action and ejecting the round.

Otherwise, ensure the action is fully forward. The KSG™ is designed to prohibit firing out of battery to protect the user.

Double Feed: A double feed may occur if there is a failure to extract. Engage the KSG™'s safety and place the magazine selector to the middle non-feed position.

Rotate the KSG™ to expose the ejection port and visually examine the malfunction. Depending on the orientation of the rounds, it is usually easiest to push the double-fed shell back into the magazine and cycle the action to clear the shell.

Otherwise, you must manually reach into the ejection port and remove the interfering shell by rotating it around the lifters as shown below.

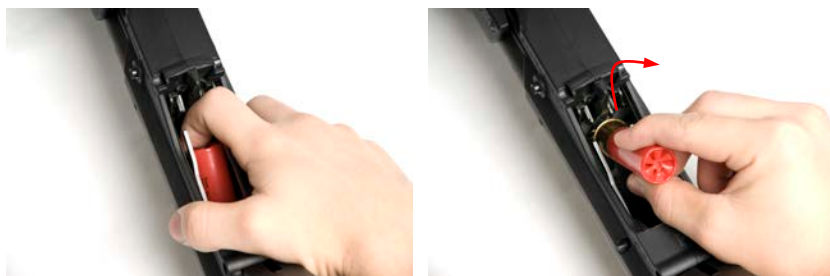

Figure F-1: Clear Double Feed by Rotating Shell Around Lifters

Magazine Selector Jammed: The magazine selector will bind if a round is not fully loaded into the magazine tubes. Ensure all shells are completely loaded into the magazines.

H. SERVICE, REPAIR, AND WARRANTY

This warranty is granted by Kel-Tec CNC Industries, Inc. P.O. Box 236009, Cocoa, FL 32923. This lifetime warranty is effective from the date of purchase and applies to the original owner of a Kel-Tec™ firearm.

Kel-Tec™ firearms are warranted to be free from defects in material and workmanship. Any such defects of which Kel-Tec receives written notice by the original owner, will be remedied by Kel-Tec without charge within a reasonable time after such notification and delivery of the product as provided below.

If your Kel-Tec™ firearm should ever require service or repair please perform the following to ensure fast and reliable service:

- 1) Include a copy of a bill of sale in the owner's name or a copy of ATF Form 4473 indicating date of purchase.
- 2) Include a written copy of the model and serial number of the firearm and a description of the difficulty experienced and service desired.
- 3) Include your name, desired return address, and a number where we can reach you.
- 4) Also include a written list of any accessories in your shipment – Kel-Tec will not be responsible for any item that was not listed and confirmed by Kel-Tec.
- 5) Be sure the firearm is completely unloaded and the shipping container is free of ammunition. It is against postal and commercial regulations to ship ammunition.
- 6) Securely package your Kel-Tec™ firearm and ship (transportation charges pre-paid) to:

Kel-Tec CNC, Inc
Service Department
1505 Cox Road
Cocoa, FL 32926

It is recommended that shipments be insured by the owner, since Kel-Tec will accept no responsibility for loss or damage in transit.

Transportation and insurance charges for return to owner will be paid by Kel-Tec if the claim is covered by the warranty.

Under no circumstances shall Kel-Tec be responsible for incidental or consequential damages with respect to economic loss or injury or property damage, whether as a result of breach of express or implied warranty, negligence or otherwise. Some States do not allow the exclusion or limitation of incidental or consequential damages, so the above limitation or exclusion may not apply to you.

Kel-Tec will not be responsible for defects resulting from careless handling, unauthorized or unsafe adjustments or modifications, non-standard, defective, or improper ammunition, corrosion, neglect, fire damage, water damage, theft, abuse, ordinary wear and tear, or unreasonable use.



DP-12

OWNER'S MANUAL

TABLE OF CONTENTS

A. Safety Information and Warnings	3
B. Overview	
Description	6
Nomenclature	6
Ammunition	7
Sling Mounting	7
C. Operating Instructions	
Safety	8
Loading Magazines	8
Chambering from Magazine	9
Manual Chamber Loading	9
Firing	10
Unloading	10
D. Disassembly	
Loosen Stock Recoil Assembly	11
Removal of Grip Assembly	12
Removal of the Bolts	13
E. Assembly	
Insertion of the Bolt	15
Lower Grip Attachment	16
F. Choke Tubes	
Removal and Installation of choke tubes	17
G. Cleaning and Maintenance	
Maintenance	18
Lubrication	18
H. Troubleshooting	
Troubleshooting	19
I. Service, Repair and Warranty	20
Parts Schematic	22

A. SAFETY INFORMATION AND WARNINGS

STATEMENT OF LIABILITY

This firearm may be classified as a dangerous weapon and is surrendered by Standard Mfg. with the understanding that the purchaser assumes all liability resulting from unsafe handling or any action that constitutes a violation of any applicable laws or regulations. Firearms can cause serious injury and death. Safety must be the prime consideration of anyone who handles firearms.

READ THESE INSTRUCTIONS AND WARNINGS CAREFULLY, BE SURE YOU UNDERSTAND THESE INSTRUCTIONS AND WARNINGS BEFORE USING THIS FIREARM.

DO NOT PUT HAND IN FRONT OF MUZZLE.

This manual should always accompany this firearm and be transferred with it upon change of ownership or when the firearm is loaned or presented to another person. A copy of the MANUAL is available FREE upon request and can also be downloaded from the internet at: <http://www.standardmfgllc.com>.

Each DP-12 also has a QR code that can be scanned with a smart phone to bring you to an on-line copy of the manual.



ALWAYS LEAVE GUN IN OPEN BOLT POSITION

READ AND CAREFULLY FOLLOW THESE WARNINGS AND INSTRUCTIONS

This Instruction Manual is designed to assist you in learning how to use and care for your **DP-12** properly. Please contact us if you have any questions about it. Failure to follow these instructions may result in improper functioning and serious injury or death.

Only when you are certain you fully understand the Manual and can properly carry out its instructions should you practice loading, etc. with live ammunition. If you have any doubts about your ability to handle or use a particular type of gun safely, then you should seek supervised instruction. Such personalized instruction is often available from gun dealers, gun clubs or police departments. If none of these sources can help you, write to the National Rifle Association, 11250 Waples Mill Road, Fairfax, VA 22030-7400. They will assist you.

The person possessing a gun has a full-time job. You cannot guess; you cannot forget. You must know how to use your firearm safely. **Do not use any firearm without having a complete understanding of its particular characteristics and safe use.**

Remember: There is no such thing as a foolproof gun.

- Only safe gun-handling habits will ensure the safe use of your firearm. This is your responsibility. Accidents are the result of violating the rules of safe gun handling noted below and common sense.
- Before handling a firearm, understand its operation.
- Never accept or pick up a firearm without checking the magazine and the chambers to assure the weapon is empty. Do not trust the extractor to clear the chambers, always look and feel to insure both chambers are empty.
- Always make sure the muzzle is pointed in a safe direction at all times.
- Never point a firearm at anyone or anything you do not intend to shoot.
- Ensure the barrel is free of obstructions prior to firing. Open the action and clear the firearm of all ammunition before checking the barrel of the unloaded firearm.
- Keep your firearm unloaded when not in use. Never keep a loaded firearm in the home or vehicle. Never store a firearm with a cartridge in the chamber.
- Never store firearms and ammunition together, keep them locked up and away from children. Use locking accessories for prevention.
- Never touch the trigger when working the action.
- Never alter any components of your firearm.
- Never take medications, drugs, or alcohol when handling firearms.
- Never load or unload a firearm without assuring the muzzle is pointed in a safe direction.
- Never load a firearm except immediately before shooting.

SAFE GUN HANDLING IS YOUR RESPONSIBILITY

Discharging firearms in poorly ventilated areas, cleaning firearms, or handling ammunition may result in exposure to lead and other substances known to cause birth defects, reproductive harm, and other serious physical injury. Have adequate ventilation at all times. Wash hands thoroughly after exposure. Never discharge a firearm without proper shooting glasses and ear protection. Never shoot at any water surface or any surface where a ricochet can occur. Never shoot until you are sure of your backstop and what lies beyond it. If the gun does not discharge after pulling the trigger, do not change its direction for at least 30 seconds, you could be having a “hang fire”, and the cartridge could go off when you do not expect it. After waiting 30 seconds open the action, remove all ammunition from the magazine and remove the unfired cases from the chambers, while keeping the firearm pointed in a safe direction. Always be aware of other people so that they cannot accidentally walk into the line of fire.

When firing on a target range, be alert and follow the range officer’s commands. Never cross obstacles such as fences or streams with a loaded firearm. Do not allow a firearm to be used by individuals who do not understand its safe operation and the rules of safe gun handling.

WARNING: After firing several rounds, the exterior metal parts of the firearm and barrels get VERY hot and can cause severe burns if touched.

Be sure all accessories are compatible with the firearm and that the accessories do not interfere with safe operation of the firearm.

When transporting your firearm, be sure your firearm is unloaded and on SAFE.

If you do not understand how to operate your DP-12 or have any questions about their safe handling, please write, call, or email us at:

Standard Mfg.

100 Burritt Street

New Britain, CT 06053

Website: <http://standardmfgllc.com>

Email: info@standardmfgllc.com

B. OVERVIEW

Description

The DP-12 is a dual-magazine 12-gauge pump action shotgun. The bullpup dual magazine feed design provides the operator with a more compact layout, increased total capacity, and with no requirement to switch between two magazines of ammunition.

The DP-12 features positive extraction and ejection, allowing it to be reliably fired in any shooting orientation. Loading and ejection are combined into a single port rearward of the grip assembly under the shotgun, enabling the DP-12 to be fired from both the dominant and non-dominant side.

The DP-12 has an integral MIL-STD-1913 Picatinny rail, located above the barrel and on the forend, that come standard with the DP-12 for mounting accessories. Unloaded, the DP-12 maintains a center of gravity over the grip assembly to facilitate ease of handling.

Nomenclature



Ammunition

The DP-12 is chambered for 12-gauge 3" shells and may safely fire both lead and steel shot. Shells 2-3/4" and shorter are also safe to fire, but anything shorter than 2-3/4" should be thoroughly tested for reliable feeding and ejection. For reference, the chamber gauge and length is indicated on the right side of the receiver of the shotgun.

WARNING: ALWAYS USE SHELLS OF THE CORRECT GAUGE AND LENGTH OR SHORTER. DO NOT USE NON-STANDARD AMMUNITION OR SHELLS WITH PRESSURES EXCEEDING SAAMI STANDARDS. FAILURE TO FOLLOW THIS WARNING MAY RESULT IN SERIOUS INJURY OR DEATH AND DAMAGE TO YOUR FIREARM. FAILURE TO FOLLOW THIS WILL VOID WARRANTY.

Only use commercially available US-manufactured ammunition that meets SAAMI established standards. Inspect your ammunition to make sure it is clean, dry, and in good condition. Never use non-standard, reloaded or damaged shells. Any other ammunition is considered non-standard and its use may void the warranty on this firearm. Standard Mfg. firearms are manufactured from high quality materials. They will provide a lifetime of service if properly maintained. However, all warranties, expressed or implied, are voided and Standard Mfg. will not be liable for property damage or personal injury and consequential damages, if faulty, non-standard, or reloaded ammunition is used in any Standard Mfg. firearm.

Sling Mounting

The DP-12 comes equipped with forward attachment points on the left and right sides of the barrel assembly as well as multiple rear attachment capabilities in the rear of the receiver.

The different sling attachment points on the DP-12 can be used to mount a 1." wide nylon sling.



ALWAYS LEAVE GUN IN OPEN BOLT POSITION

C. OPERATING INSTRUCTIONS

Safety

The DP-12 features an AR type rotary safety located behind and above the trigger on the grip assembly. When the safety is activated, it blocks the sear from releasing and prevents the trigger from being pulled. Please note that the safety will not engage unless the hammer is cocked. The safety is rotated with the right or left thumb until a click is heard and the pointer selects the desired mode “SAFE” or “FIRE”



WARNING: NEVER TOTALLY RELY ON YOUR MECHANICAL SAFETY AS IT CAN FAIL OR UNINTENTIONALLY BE DISENGAGED. YOUR MECHANICAL SAFETY IS NOT A SUBSTITUTE FOR SAFE GUN HANDLING PRACTICES.

Loading Magazines

1. Ensure your muzzle is pointed in a safe direction before loading.
2. Engage the safety by ensuring the pointer is selecting the “SAFE” position.
3. Ensure the forend is not in the rearmost position. If so, move the forend and slide assembly forward. Slide the action closed with chambers empty so that the bolt sled will aid in locating the ammunition.
4. With fingers on the base of the round, insert the round into the loading/ejection port and slide the round into the magazine using your fingers as shown in Figure C-1. The rounds should slide under and should be held in place by the magazine hooks.
5. The magazine hooks must be pulled up to manually release shells from the magazine tubes.



Figure C-1: Loading Shells into the Magazine Tubes

Magazines can be filled simultaneously by using two fingers while the firearm is stable upside down and pointed in a safe direction.

Chambering from Magazine

1. The magazines may be filled to capacity with 7 2 3/4" shotshells in each tube, less rounds may be used, if desired.
2. Pull down the action bar release on the trigger guard and maintain downward pressure to unlock forend. See Figure C-2.
3. Actuate the forend fully rearward and then fully forward to chamber two rounds from the magazine tubes, one in each barrel.
4. The gun is ready to fire with the "SAFETY" on. One round may now be placed into each of the magazine tubes to replace the 2 that have been chambered.

CAUTION: DO NOT HOLD THE FOREND BEHIND THE PICATINNY RAIL. DOING SO WILL SHORT STROKE THE ACTION AND PINCH YOUR HAND.



Figure C-2: Action bar release

Manual Chamber Loading

The procedure for loading a shell directly into the chamber of the DP-12 is different than most other shotguns because of the combined loading and ejection port. To load a shell into the chamber of the DP-12, use the following procedure as a guideline.

1. Ensure your muzzle is pointed in a safe direction before loading.
2. Engage the safety by ensuring the pointer is selecting "SAFE".
3. Pull down the action bar lock and maintain downward pressure to unlock forend.
4. Actuate the forend so that it is about a 1/2" from the rearmost position. Inspect that the shell lifters are down against the top of the receiver and are not blocking access to the chamber.
5. Place a shell or 2 shells in chamber and cycle the action forward to chamber the inserted shells.

ALWAYS LEAVE GUN IN OPEN BOLT POSITION

Firing

1. Load a shell or two shells into the chamber of the DP-12 manually or from the magazine, as instructed above.
2. Aim at the target, taking notice of the target's backdrop.
3. Disengage the safety, rotating it so the pointer selects "FIRE".
4. Place trigger finger into trigger guard.
5. When the trigger is depressed the DP-12 will fire the right barrel. Release the trigger and depress again to fire the left barrel. Cycle the action to eject the empty cases and feed two new rounds from the loaded magazine tube into the chambers.

IF YOU DO NOT RELEASE THE TRIGGER AFTER FIRING THE FIRST ROUND THE SECOND SEAR ENGAGEMENT WILL NOT SETUP

Unloading

1. Ensure your muzzle is pointed in a safe direction before unloading.
2. Engage the safety by rotating the pointer to "SAFE".
3. **ENSURE THAT ALL FINGERS ARE CLEAR OF THE TRIGGER.**
4. Pull down the action bar lock and maintain downward pressure to unlock forend.
5. Cycle action back and forth repeatedly using the forend, loading and extracting live ammunition until the magazine followers are visible and the chambers are empty.
6. When the DP-12 is fully unloaded both magazine followers should be visible from the ejection port and the chamber should be visibly empty.
7. With the forend in its rearmost position, always visually and tactually check the chamber to confirm the firearm is unloaded.
8. To keep the firearm safe, keep action open to the rearward position and insert the locking bracket in front of the forend between the barrels and the magazine tubes. Use the supplied padlock to prevent child access.
9. The rounds in the magazine tubes may be removed manually by lifting the magazine tube hooks. This cannot be done with the forend assembly and bolts at their rearward position. Move the forend assembly forward so the lifters fall to the inside top of the receiver. Pull up on the magazine release hooks to release contained rounds. Always return forend assembly to the rearmost position and inspect that the chambers are empty, both visually and tactually.

D. DISASSEMBLY

For regular maintenance of the DP-12 only cleaning and lubricating will be necessary. In order to remove debris or thoroughly clean and lubricate the action, it will be necessary that you become familiar with its disassembly. The following sections should be followed in sequential order and continued as needed depending on desired maintenance.

WARNING: ALWAYS ENSURE THE DP-12 IS CLEAR OF ALL AMMUNITION BEFORE ATTEMPTING DISASSEMBLY. IF THE DP-12 HAS BEEN FIRED, WAIT A SUFFICIENT AMOUNT OF TIME FOR THE COMPONENTS TO COOL BEFORE ATTEMPTING DISASSEMBLY.

Loosen Stock Recoil Assembly

1. Ensure that the firearm chambers and magazine tubes are completely empty and the muzzle is pointed in a safe direction.
2. Inspect that safety is selecting "SAFE."
3. Access the shoulder screws through the large holes in the recoil pad with an allen wrench and remove the recoil pad assembly with springs. See Figure D-1.



Figure D-1: Removal of recoil pad assembly

4. Loosen the socket head cap screws in the recoil pad shroud at least 1 1/2 turns. See Figure D-2.



Figure D-2: Loosening of socket head cap screws

ALWAYS LEAVE GUN IN OPEN BOLT POSITION

Removal of Grip Assembly

1. Slide forend assembly back to open the action and inspect that chambers and magazines are empty.
2. Inspect pointer is selecting “SAFE” mode.
3. Remove the rear assembly pin located at the rear of the receiver just in front of the recoil pad shroud. See Figure D-3.
4. On each side of the firearm remove the socket screws at the front of the receiver just below the magazine tubes. See Figure D-4.
5. Adjust the position of the forend rearward so that the front socket screw of the lower grip assembly can be accessed through the hole in the forend just in front of the lower 3 slots in the forend. Loosen and remove the screw completely. See Figures D-5 and D-6.



Figure D-3: Removal of rear assembly pin



Figure D-4: Remove socket screws



Figure D-5: Loosen and remove screws



Figure D-6: Remove screws

6. Remove the grip assembly by lifting the rear of the assembly sliding angularly against the back of the receiver as shown in Figure D-7.



Figure D-7: Remove grip assembly

7. It is best to slide the forend assembly forward. Begin removing the assembly by rocking the front of the grip assembly away from the magazine tubes slightly. Then slide the grip assembly away at an angle parallel to the rear of the receiver. Return screws and pin to their original locations. See Figure D-7 and D-8.



Figure D-8: Pull rear away from aluminum action.

8. Grip the lower assembly as shown in Figure D-8 and pull front up slightly.

Removal of the Bolts

1. With the grip assembly removed the bolt retainer plate may be removed to access the bolt sled and bolts. Remove the flat head socket screws on each side (See Figure D-9) of the receiver to the rear of the irregular “U” shaped notch in the receiver bottom. Slide the black anodized bolt retainer plate approximately 1/4” forward so that its rear corners are free from the notches in the sides of the receiver. Lift directly up and out of the receiver. See Figure D-10.



Figure D-9: Remove socket screws (both sides)



Figure D-10: Slide the retainer plate forward and lift up and out.

2. The bolt and bolt sled should now be resting in the receiver of the DP-12 and can be removed by reaching in and lifting out the bolt sled as shown in Figure D-11.

Figure D-11: The bolt and bolt sled resting in the receiver.



ALWAYS LEAVE GUN IN OPEN BOLT POSITION

3. With the bolt retainer plate out, slide forend assembly to rear position. Then slide the forend assembly 1/2" to 5/8" forward so that you can see the rear outer corners clear in front of the trigger retainer plate notch. The bolt sled can then be lifted straight up through widest opening in the receiver, See Figure D-12.

Figure D-12: Remove bolt sled

**DO NOT TILT
WHILE LIFTING
BOLT SLED OUT**



4. The 2 separate bolts may then be lifted out of the receiver. To reinstall bolts note that they must be positioned so that the bolt faces are approximately 5/8" forward of the front of the bolt sled at the sled entry and egress locations. The slide arm assembly must also be positioned so the notches engage the bolt sled correctly(See Figure D-11). See Figure D-13.

Figure D-13: Remove
Exposed Bolt from Receiver

**Note that the slidearm
bumps are in their notches
in the bolt sled.**



**CAUTION: FURTHER DISASSEMBLY SHOULD ONLY BE
PERFORMED BY A CERTIFIED GUNSMITH OR STANDARD MFG.
ATTEMPTING FURTHER DISASSEMBLY COULD VOID YOUR
WARRANTY.**

E. ASSEMBLY

Insertion of the Bolts

1. Cycle the forend completely rearward before attempting to insert the bolts.
2. Insert the bolts rounded side down against the inside top of the receiver with the extractor hooks up towards bottom of the receiver and forward towards the barrels. Position the bolts side by side approximately 5/8" forward of their rearward position. The rear of the extractor hooks should be slightly behind the front edge of the cutout in the receiver for installing and extracting the bolt retainer plate and bolt sled. This cutout jog is in the center of the "U" shaped cutouts in the sides of the receiver for the hammer pivot.
2. Align the notch in the outer forend slide bars so the front edge of the notch is even with the rear of the ejector hooks. See Figure D-13. Hold the bolt sled so the lock bumps are down and the 4 thin legs are rearward, the 2 smooth shallow channels facing towards you. Lower the bolt sled down through the receiver cutout; the sled must be held horizontally so that its sides slide against the inner walls of the cutout in the receiver. See Figure E-2. The slide arm assembly might need to be moved slightly back and forth so that the 3/8" cutout in the sides of the bolt sled capture the rear bumps on the outer slide arms. See Figure E-3. The lock bumps of the sled should fall into the bolts and then moving the forend assembly back and forth should move both bolts and sled back and forth for the full travel. Slide the forend assembly forward so that the sled is captured in the side slots of the receiver.



Figure E-1: Align the cutout



Figure E-2: Lower the bolt sled

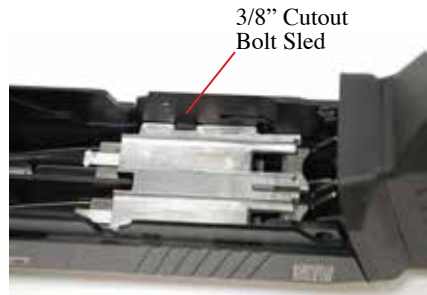

Figure E-3: Move back and forth to capture bumps on the slide arms

ALWAYS LEAVE GUN IN OPEN BOLT POSITION

3. Hold the bolt retainer plate so the large rectangular bump with threaded holes are facing you and positioned forward towards the barrels. Slide the bolt retainer plate down through the cutout in the receiver just behind the “U” shaped cutouts in the receiver sides. See Figure E-4.

Figure E-4: Slide the bolt retainer plate down through the cutout



Move the bolt retaining plate down and then rearward so that the rear outside corners enter the 1/8” horizontal slots in the receiver sides. The threaded holes should then align with the counter sink holes in the sides of the receiver. Install the #5-40 flat head screws in each side. See Figure E-5



Figure E-5: Install the flat head screws.

LOWER GRIP ATTACHMENT

1. The hammers must be pulled rearward and cocked before installing lower grip assembly. The forend assembly must be forward and bolts closed in breech.
2. Carry out steps 8 through 3 in D. Disassembly: Removal of Lower Grip Assembly.

F. CHOKE TUBES

The DP-12 comes with 2 choke tubes threaded into the muzzle end of each barrel. It is imperative that they be removed and cleaned regularly.

BEFORE REMOVAL OR INSTALLATION OF CHOKE TUBES, MAKE SURE THE FIREARM IS UNLOADED AND THE MUZZLE IS POINTED IN A SAFE DIRECTION.

Removal of Choke Tubes

1. To change or remove the choke tubes, find the wrench that was supplied.
2. Align either stepped end of the tool with the notches in the choke tube as shown in Figure F-1. Turn counter clockwise.



Figure F-1: Turn counter clockwise to remove choke tubes.

Installing Choke Tubes

1. Start new choke tubes into the muzzle with the threaded end entering the barrel first and the 4 notches pointing away from the barrel.
2. Turn clockwise, starting threads by hand.
3. Use supplied tool to tighten.

G. CLEANING AND MAINTENANCE

Maintenance

Your DP-12 is a precision instrument and will provide a lifetime of faithful service if it is properly cleaned and maintained. It is recommended that you clean your DP-12 after every shooting session or more frequently if needed. Be sure to unload your DP-12 (see Unloading on pg. 10) before performing any cleaning or maintenance procedures.

CAUTION: NEVER USE AUTOMOTIVE BRAKE CLEANER OR ANY SOLVENT NOT DESIGNED FOR POLYMER FIREARMS. DOING SO MAY DAMAGE THE FIREARM AND VOID YOUR WARRANTY.

1. Thoroughly clean all exterior sides of the bolt and receiver with solvent and brush.
2. Brush the barrel bore and chamber with a good powder removing solvent and bore brush. Wipe the areas clean with patches or a swab.
3. Using a small brush dipped in solvent, remove all deposits from around the breech of the barrel and barrel extension, as well as all adjacent areas that have been subjected to powder or primer residue.
4. Clean the magazine tubes with solvent and brush if needed.

Lubrication

After cleaning the entire gun, use a cloth to apply a light coating of high quality gun oil to all internal and exterior metal surfaces and wipe clean. If the need arises to lubricate the grip assembly, do so through the top of the assembly. Manually cycle the action back and forth to check the function of the firearm. If any parts are damaged or badly worn or the firearm does not work correctly the firearm should not be fired and should be returned to Standard Mfg. for servicing immediately.

WARNING: DISCHARGING A FIREARM WITH OIL, GREASE, OR ANY OTHER MATERIAL EVEN PARTIALLY OBSTRUCTING THE BORE COULD RESULT IN SERIOUS INJURY OR DEATH AND SERIOUS DAMAGE TO YOUR FIREARM.

H. TROUBLESHOOTING

Proper functioning of your firearm is directly related to proper maintenance and care as well as the quality of ammunition you use. If in the unlikely circumstance your DP-12 malfunctions, we have included a list of several suggested remedies below.

If the DP-12 Fails to Fire: You may be experiencing a misfire and should point the barrel of the DP-12 in a safe direction, engage the safety by ensuring the pointer is selecting “SAFE”, and wait at least 30 seconds before fully cycling the action and ejecting the round. Otherwise, ensure the action is fully forward. The DP-12 is designed to prohibit firing out of battery to protect the user.

Double Feed: A double feed may occur if there is a failure to extract.

Rotate the DP-12 to expose the ejection port and visually examine the malfunction. Depending on the orientation of the rounds, it is usually easiest to push the double-fed shell back into the magazine and cycle the action to clear the shell.

Otherwise, you must manually reach into the ejection port and remove the interfering shell by rotating it around the shell lifters as shown below.



Figure F-1: Clear Double Feed by Rotating Shell Around Lifters

Magazine tube shell hooks will not operate with action in its rearward position. Move the forend assembly forward and raise hooks to empty the magazine tubes.

I. SERVICE, REPAIR, AND WARRANTY

This warranty is granted by Standard Mfg. . This 1 year warranty is effective from the date of purchase and applies to the original owner of a Standard Mfg. firearm. Standard Mfg. firearms are warranted to be free from defects in material and workmanship. Any such defects of which Standard Mfg. receives written notice by the original owner, will be remedied by Standard Mfg. without charge within a reasonable time after such notification and delivery of the product as provided below. If your Standard Mfg. firearm should ever require service or repair please perform the following to ensure fast and reliable service:

- 1) Include a copy of a bill of sale in the owner's name or a copy of ATF Form 4473 indicating date of purchase.
- 2) Include a written copy of the model and serial number of the firearm and a description of the difficulty experienced and service desired.
- 3) Include your name, desired return address, and a number where we can reach you.
- 4) Also include a written list of any accessories in your shipment – Standard Mfg. will not be responsible for any item that was not listed and confirmed by Standard Mfg..
- 5) Be sure the firearm is completely unloaded and the shipping container is free of ammunition. It is against postal and commercial regulations to ship ammunition.
- 6) Securely package your Standard Mfg. firearm and ship (transportation charges pre-paid) to:

Standard Mfg.

Service Department

100 Burritt Street

New Britain, CT 06053

It is recommended that shipments be insured by the owner, since Standard Mfg. will accept no responsibility for loss or damage in transit.

Transportation and insurance charges for return to owner will be paid by Standard Mfg. if the claim is covered by the warranty.

Under no circumstances shall Standard Mfg. be responsible for incidental or consequential damages with respect to economic loss or injury or property damage, whether as a result of breach of express or implied warranty, negligence or otherwise. Some States do not allow the exclusion or limitation of incidental or consequential damages, so the above limitation or exclusion may not apply to you.

Standard Mfg. will not be responsible for defects resulting from careless handling, unauthorized or unsafe adjustments or modifications, non-standard, defective, or improper ammunition, corrosion, neglect, fire damage, water damage, theft, abuse, ordinary wear and tear, or unreasonable use.

ITEM NO.	DESCRIPTION	PART NO.	QTY.
1	DBL PUMP RECEIVER	DP 0001	1
2	DBL PUMP MAG RELEASE PIVOT BLOCK	DP 0002	1
3	DBL PUMP RECOIL PAD	DP 0004	1
4	DBL PUMP MAG TUBE UNION	DP 0005	1
5	DBL PUMP HAMMER TRF RIGHT	DP 0006	1
6	DBL PUMP MAGAZINE SHELL RELEASE	DP 0007	2
7	MAG TUBE SHELL KEEPER	DP 0008	1
8	DBL PUMP HAMMER	DP 0009	2
9	DBL PUMP HAMMER SPRING	DP 0010	4
10	DBL PUMP HAMMER LINK PIN	DP 0012	4
11	DBL PUMP BOLT	DP 0013	1
12	DBL PUMP BOLT SLIDE	DP 0014	1
13	DBL PUMP BOLT LOCK	DP 0015	2
14	DBL PUMP PRING PIN	DP 0016	2
15	DBL PUMP BARREL TUBE LEFT	DP 0017	1
16	DBL PUMP HAMMER TRF LEFT	DP 0018	1
17	DBL PUMP HAMMER MAIN SPRING PIN	DP 0019	1
18	DBL PUMP HOUSING LEFT OF NYLON	DP 0017CM	1
19	DBL PUMP PAD SHROUD	DP 0020	1
20	DBL PUMP STOCK SUPPORT	DP 0023	1
21	DBL PUMP TRIGGER	DP 0024	1
22	DBL PUMP RIGHT SHROUD	DP 0025	1
23	DBL PUMP HOUSING RIGHT OF NYLON	DP 0017CM	1
24	DBL PUMP LEFT SHROUD	DP 0028	1
25	DBL PUMP RECOIL PLATE	DP 0029	1
26	DBL PUMP RELEASE BUTTON	DP 0030	1
27	DBL PUMP FOREND LEFT	DP 0031	1
28	DBL PUMP FOREND RIGHT	DP 0032	1
29	DBL PUMP SEAR RIGHT	DP 0033	1
30	MAG KEEPER RELEASE BAR	DP 0034	1
31	DBL PUMP RELEASE BAR POSITION SPRING	DP 0035	1
32	M3 SOCKET HEAD CAP SCREW X 1/4	DP 0036	9
33	DBL PUMP BARREL TUBE RIGHT	DP 0037	1
34	DBL PUMP MUZZLE SUPPORT	DP 0038	1
35	DBL PUMP FOREND RELEASE	DP 0039	1
36	DBL PUMP TRIGGER RETURN SPRING	DP 0040	1
37	PCATINNY RAIL	DP 0042	1
38	DBL PUMP EXTRACTOR	DP 0043	2
39	DBL PUMP LIFTER	DP 0044	2
40	DBL PUMP RECOIL SPRING	DP 0045	2
41	DBL PUMP MAG TUBE	DP 0050	2
42	DBL PUMP BARREL NUT	DP 0051	2
43	DBL PUMP MAG THREADED END	DP 0052	2
44	DBL PUMP BARREL HOLD BOLT	DP 0053	2
45	DBL PUMP TOP RAIL	DP 0054	1
46	DBL PUMP MAG SPRING	DP 0055	2
47	MAGAZINE TUBE PLUNGER	DP 0056	2
48	DBL PUMP SLIDE ARM LEFT	DP 0057	1
49	DBL PUMP FOREND BRACKET	DP 0058	1
50	M3 SOCKET HEAD CAP SCREW X 1/8	DP 0059	3
51	QUICK PIN CLEVIS	DP 0060	1
52	DBL PUMP HAMMER PIVOT PIN	DP 0061	1
53	DBL PUMP HAMMER LINK DIVIDER	DP 0062	1
54	MAG TUBE RELEASE PIVOT PIN	DP 0063	1
55	DBL PUMP TRIGGER/SEAR PIN	DP 0064	2
56	DBL PUMP BOLT PLATE	DP 0065	1
57	DBL PUMP TRIGGER RETURN SPRING	DP 0066	1
58	MAG TUBE HOOD RELEASE Y SPRING	DP 0067	1
59	#8-32 BUTTON HEAD CAP SCREW X 3/8	DP 0068	4
60	ECUP	DP 0069	1
61	1/4-20 X .3125 SHOULDER SCREW	DP 0070	2
62	#8-32 SOCKET HEAD CAP SCREW	DP 0071	2
63	M3 HEX NUT SELF LOCKING	DP 0072	2
64	DBL PUMP RESTORE/RELEASE PIN	DP 0073	2
65	DBL PUMP ALIGNMENT SLOT LEFT	DP 0074	1
66	DBL PUMP TRIGGER ROLL PIN LONG .042	DP 0076	1
67	DBL PUMP HAMMER LINK RIGHT	DP 0077	1
68	#8-32 BUTTON HEAD CAP SCREW X 1/4	DP 0078	2
69	#6-32 LOW HD SOCKET CAP SCREW	DP 0079	4
70	DBL PUMP TRIGGER RESET RIGHT	DP 0080	1
71	DBL PUMP ALIGNMENT PIN PLATE	DP 0081	2
72	DBL PUMP SELECTOR BAR	DP 0082	1
73	DBL PUMP TRIGGER BAR SPRING	DP 0083	1
74	DBL PUMP TRIGGER SELECTOR BAR PIN	DP 0084	1
75	DBL PUMP TRIGGER SELECTOR BAR PIN	DP 0085	1
76	DBL PUMP CARRIER PIVOT PIN	DP 0086	1
77	DBL PUMP HAMMER SPACERS	DP 0087	4
78	DBL PUMP ADJUST PLATE	DP 0088	1
79	DBL PUMP SAFETY BUTTON	DP 0090	1
80	DBL PUMP SAFETY END CAP	DP 0090-2	1
81	DBL PUMP SAFETY DETENT SPRING	DP 0091	2
82	DBL PUMP SAFETY DETENT PLUNGER	DP 0092	2
83	DBL PUMP RELEASE HOOK SPRING 2	DP 0093	3
84	DBL PUMP SEAR SPRING	DP 0094	2
85	DBL PUMP FOREND RELEASE SPRING	DP 0095	1
86	DBL PUMP RESET SPRING	DP 0096	1
87	RESET ROLL PIN .25 X .0425	DP 0097	3
88	DBL PUMP BRACKET RESET LEFT	DP 0098	1
89	DBL PUMP HAMMER LINK LEFT	DP 0099	2
90	DBL PUMP BARREL EXTENSION RIGHT	DP 0100	1

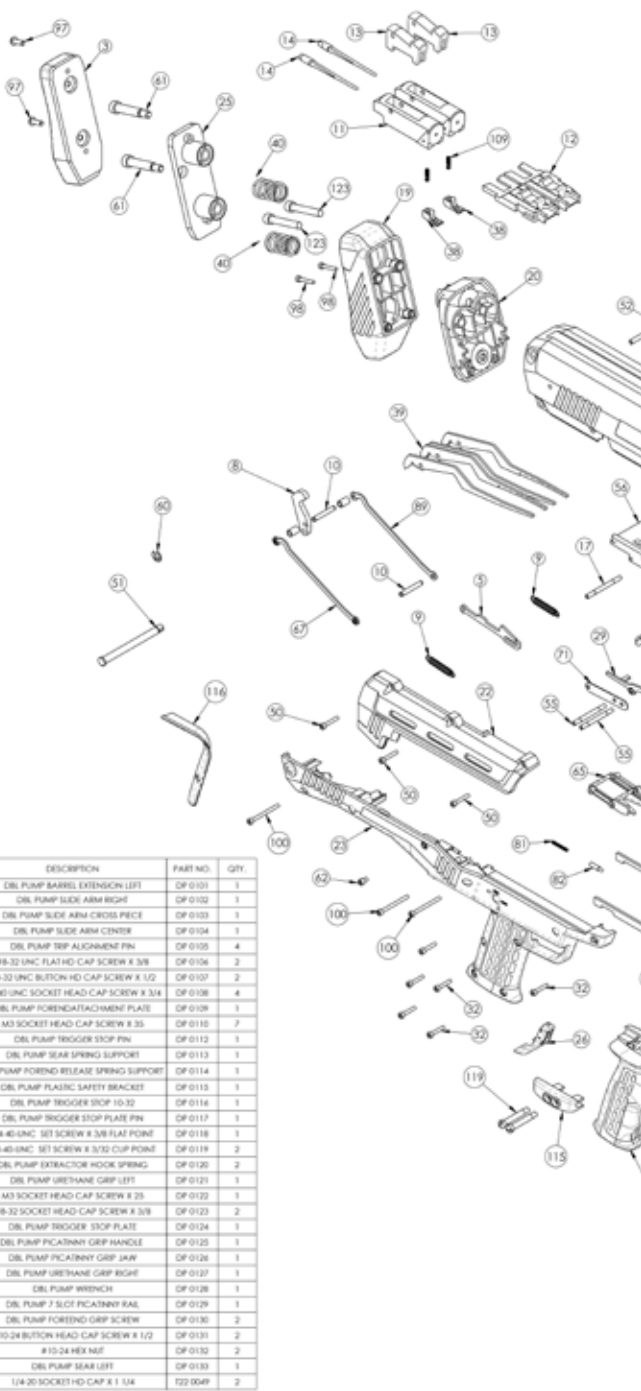



**READ THE INSTRUCTIONS AND
WARNINGS IN THIS MANUAL CAREFULLY
BEFORE USING THIS FIREARM**

**For Product Service on This Model Please Email:
service@standardmfgllc.com**

**THIS INSTRUCTION MANUAL SHOULD ALWAYS ACCOMPANY THIS
FIREARM AND BE TRANSFERRED WITH IT UPON CHANGE OF
OWNERSHIP, OR WHEN THE FIREARM IS LOANED OR PRESENTED TO
ANOTHER PERSON**